



SAR M41/43 & M41/43 ES



WARNING

- FOR AGE 18 OR ABOVE.
- PLEASE READ THE INSTRUCTIONS CAREFULLY BEFORE USE. MISUSE OR CARELESS USE MAY CAUSE SERIOUS INJURY.
- USER SHOULD OBEY TO THE LAWS REGARDING THE USAGE AND OWNERSHIP OF AIRSOFT ELECTRIC GUNS.
- FACIAL PROTECTION IS REQUIRED.

Begadi holds the worldwide exclusive licence for Schwaben Arms GmbH / SAR in airsoft industry



CLASSIC ARMY AUTOMATIC ELECTRIC GUN SERIES

1 Outlook / Structure of CA33E

Always set the selector switch to the safe position when you are not firing or during storage

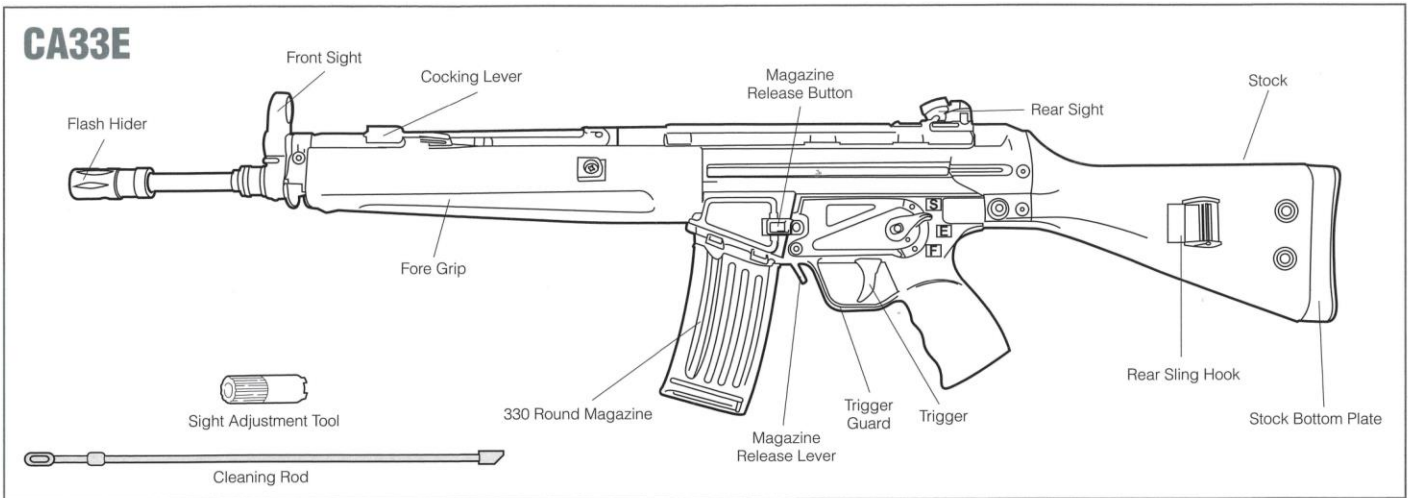

2 Specification

Data of Automatic Electric Gun

| | | |
|----------------------|-------------------|--|
| Name | CA33E |  |
| Weight | 2.8 kg | |
| Barrel Length | 429mm | |
| Barrel Caliber | 6.08mm | |
| Pellet Capacity | 330 | |
| Pellet | 6mm BB | |
| Initial Pellet Speed | 105-130m/s | |
| Battery Type | Large Type (8.4V) | |

3 Operation

1 How to use safety lock

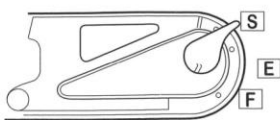

S : Safety Lock

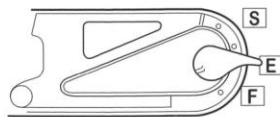

E : Single Lock

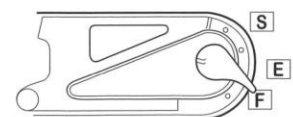

F : Full Auto

2 Magazine Attachment / Detachment procedure

High precision is required for the operation of this magazine. Avoid invasion by dust and dirt into the magazine to prevent malfunctions.

Action against Problem

Failure in pellet feeding may occasionally occur during full auto operation. In this case, disconnect the magazine, give a slight shock or poke BB pellets using a stick and then set the magazine again.



About 30 pellets remain in the duct after operation. Be careful with the pellets which will fire out if you hold the gun up-side-down and pull the trigger.

Ensure Smooth Pellet Feeding

- Occasionally give slight shocks to the gun or shake vertically for ensuring smooth pellet feeding.
- Slightly turn the gear after every 50 to 60 pellets for ensuring smooth pellet feeding.

1 Press the magazine catch to detach the magazine



2 Open the top hatch and insert BB pellets. About 330 pellets can be loaded. (Avoid forcing BB pellets into the magazine.)

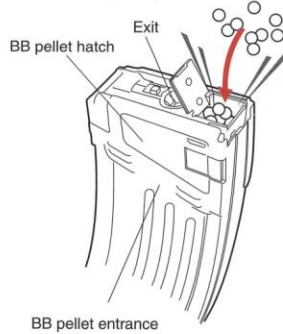

3 Close the hatch
pellet stopper releasing lever

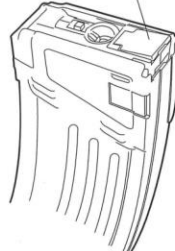

- Remove pellets remaining in the duct by reversing the magazine and using the release lever as shown. This ensures smooth operation next time.

4 Hold the magazine with BB pellet entrance facing upward. Turn the gear at the bottom all the way until the click-click sounds change. (If only a small number of BB pellets are inserted, the gear merely makes blank turning.)

Turn the gear all the way until the sound changes.
The gear will not be damaged even if you turn it excessively.



5 Check the BB pellets whether they are lifted up to the exit, and then connect the magazine to the gun.



If pellet feeding is frequently in fault, remove all pellets from the magazine and spraysilicone oil for 1 to 2 sec. Note that the hop-up operation may become unstable for a while after using silicone oil.

3 How to insert battery

Set the battery after charging

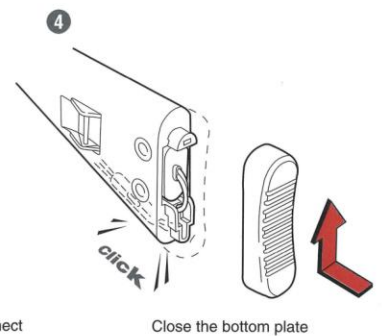
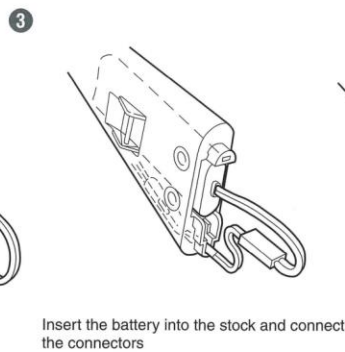
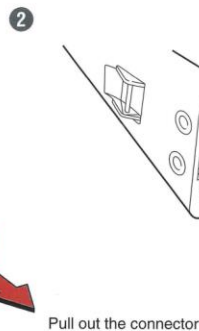
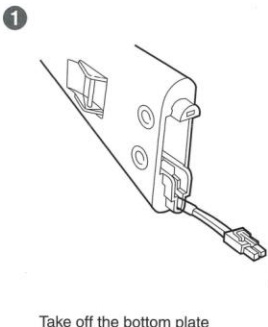

CAUTION • Be careful with your fingers

4 How to fire

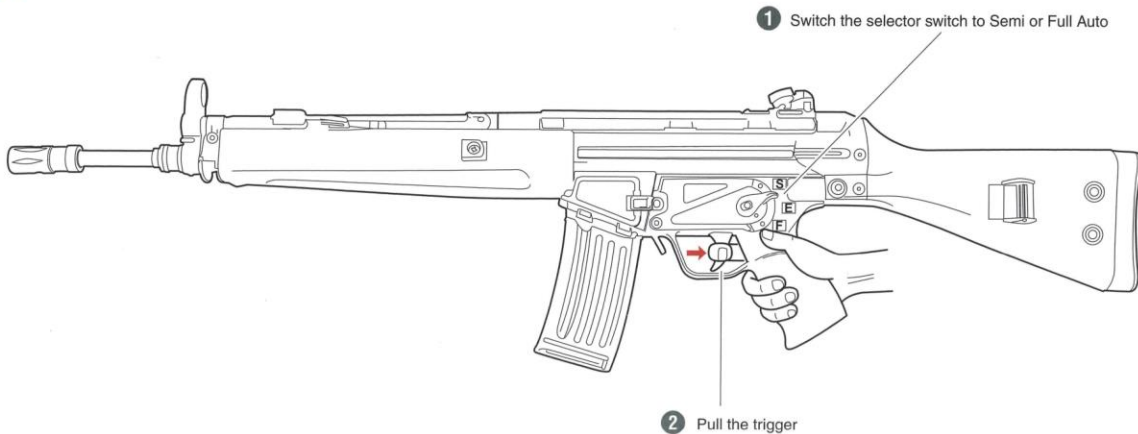

CAUTION

- There are possible cases that no firing occurs after pulling the trigger in the semi auto mode. In case, do not pull the trigger furiously. Fire 5 to 10 pellets in the full auto mode and then return to the semi auto mode.

CAUTION

- Smell may be generated from the motor for a while when a new air gun is operated, this is the normal operation of the gun.

CAUTION

- The hop up operation may be unstable for 200 to 300 pellets after using silicone oil, this is the normal operation of the gun.

* A blank firing may occur at triggering after setting the magazine, this is the normal operation of the gun.

Cautions on Motor and Battery

- Change the battery if the firing cycle becomes slow.
- Give the air gun a rest for 5 to 10 minutes after firing about 500 pellets, in order to ensure high durability of the motor and battery.

When pellets are clogged

- If pellets are clogged, remove them and apply a few drops of silicone oil into chamber from the magazine entrance as shown or spray silicone oil for 0.5 to 1 sec to obtain smooth continuous firing. (Never use CRC-556 or other mineral oil)

4 Maintenance

1 How to use a cleaning rod

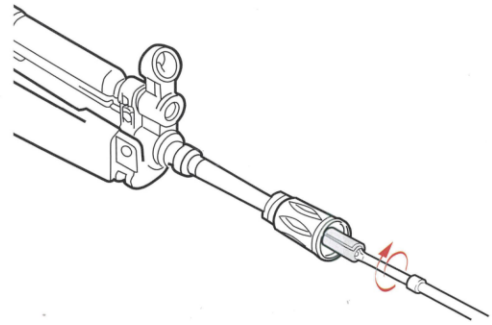
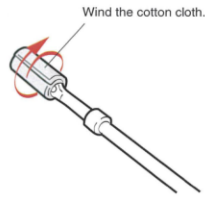
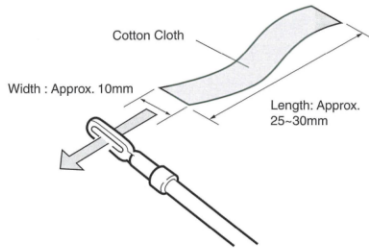

Cut a cotton cloth to the size shown above and insert one end into the hole in the rod. (Adjust the length of cloth for smooth entry into the barrel.)

Hold the tip of the rod and insert it with turning motion.



CAUTION: Always begin the maintenance by returning the Hop Up adjustment lever to NORMAL.



CAUTION: The chamber is a precision component. Never use any used BB pellets.

*The hop-up performance may become unstable for 60 to 70 pellets after maintenance.



Inserting the rod will be difficult if you hold the rod at the end.

- 1 Spray silicone oil for 0.5 to 1 sec in the pellet entrance, then fire 40 or 50 pellets to make the magazine more stable.
- 2 Clean up the oil from the chamber by using the cleaning rod (with cotton) to complete the maintenance.

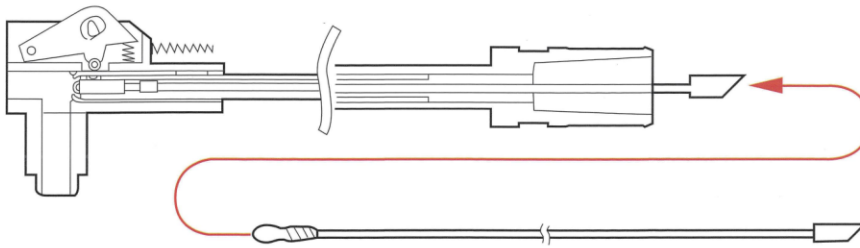

CAUTION: Always begin the maintenance by returning the Hop Up adjustment lever to Normal.

2 How to replace the fuse

- 1 Open the cover and pull out the fuse box

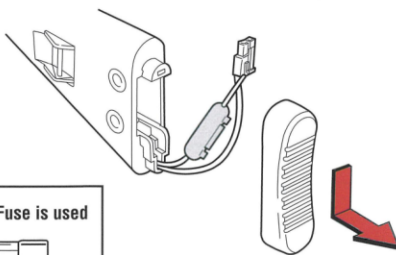

- 2 Change the fuse and place the fuse box back under the rib

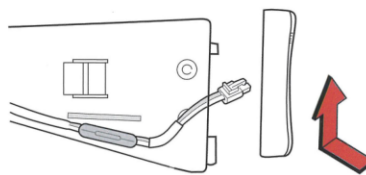

20A Glass Tube Fuse is used



Never use any used BB pellets



Using new 6mm BB pellet is a must



Please don't use the BB pellet which is not completed.

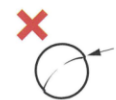

Please don't use the broken BB pellet.

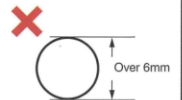

Please don't use the BB pellet which diameter is exceeded 6 mm.

5 Rear Sight Adjustment

- 1 The sight is adjustable to four positions.

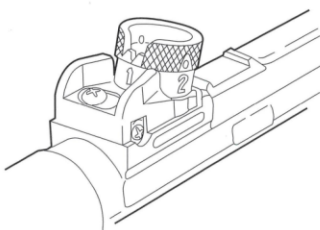

- 2 Loose it out by a screw driver.

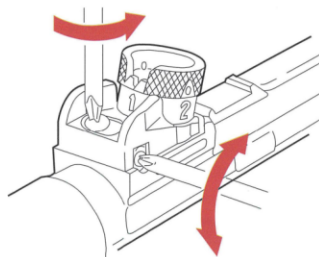

6 Proper Disassembling

1 Take off the pin before opening the fore grip.

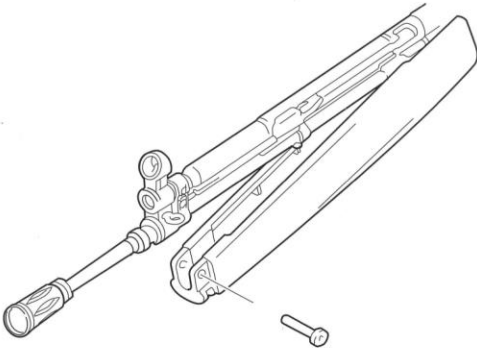

2 Take off the pin & pull out the stock. Be careful with the connector.

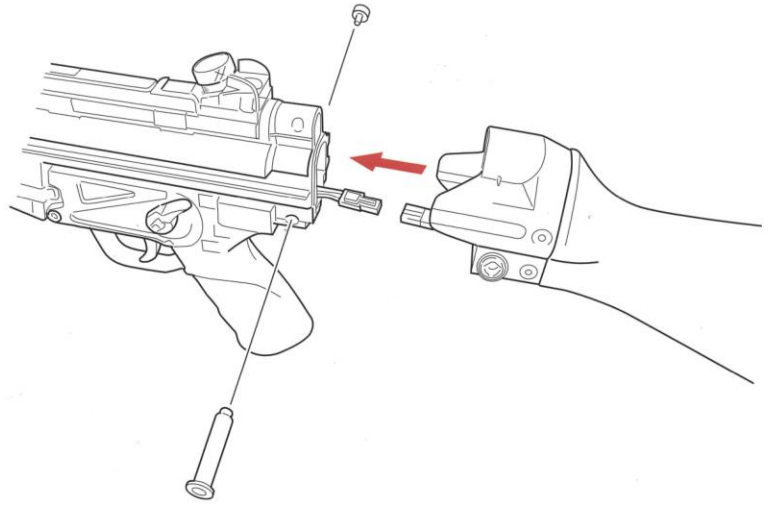

3 Take off the pin, then pull out the grip & gear box.

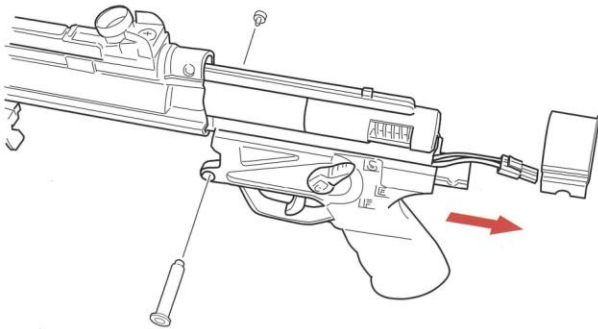

4 Pull out the barrel.

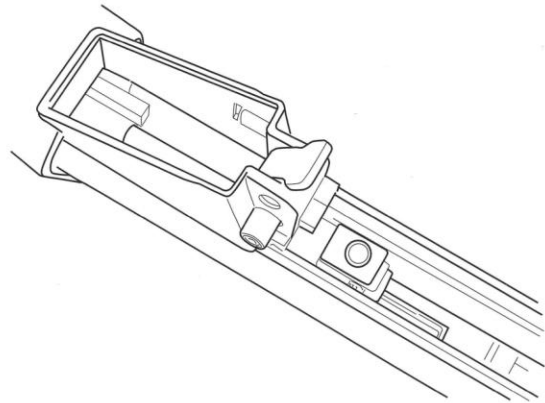

5 Pull the cocking lever for checking the hop-up chamber.

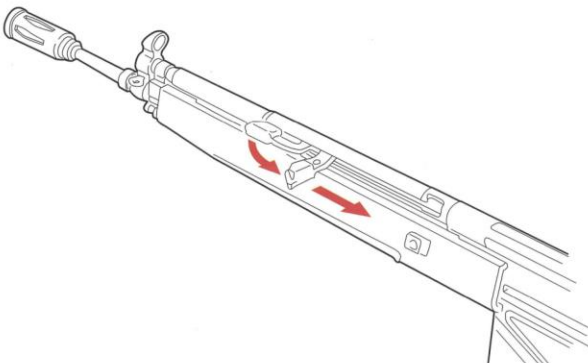

6 Use the sight adjustment tool to adjust the hop-up chamber.

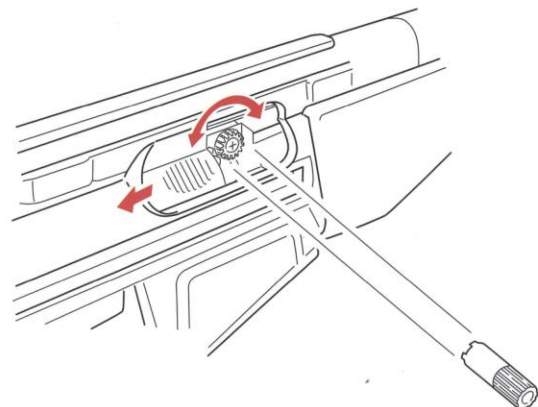

Sight Adjustment Tool

6 ! WARNING

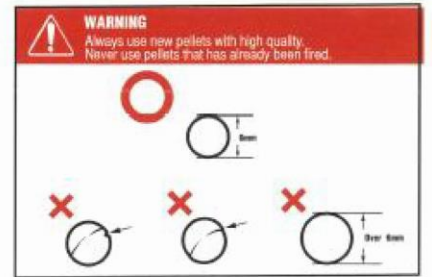

In no event shall Classic Army or any of our partners be liable for any direct or indirect, special, incidental, or consequential damages in connection with the use of our products.

7 For complete product information, dealer locations and technical support, please visit the website of Classic Army Sole Distributors .

Worldwide Distributer for CA SAR Series

Begadi GmbH German

www.begadi.com | Visit us on Facebook! <https://www.facebook.com/begadi.germany>

Begadi GmbH, Germany | Dietingerstr. 23 | D-78661 Boehringen

Geschäftsfuehrer / CEO: Benjamin Digeser / Gabriel Digeser

SAR and the SAR Logo are registered trademarks of Schwaben Arms GmbH Germany!

BEGADI holds the worldwide exclusive rights for manufacturing SAR rifles and models as airsoft guns and replicas. For information where to buy or for obtaining a retailers license, please contact us directly!

PLEASE NOTE: We do not take any responsability or warranty, for SAR Models, which were not purchased by a authorized retailer or distributor! If you are in doubt about a retailer or distributor, contact us directly via www.begadi.com!



8 Exploded Diagram

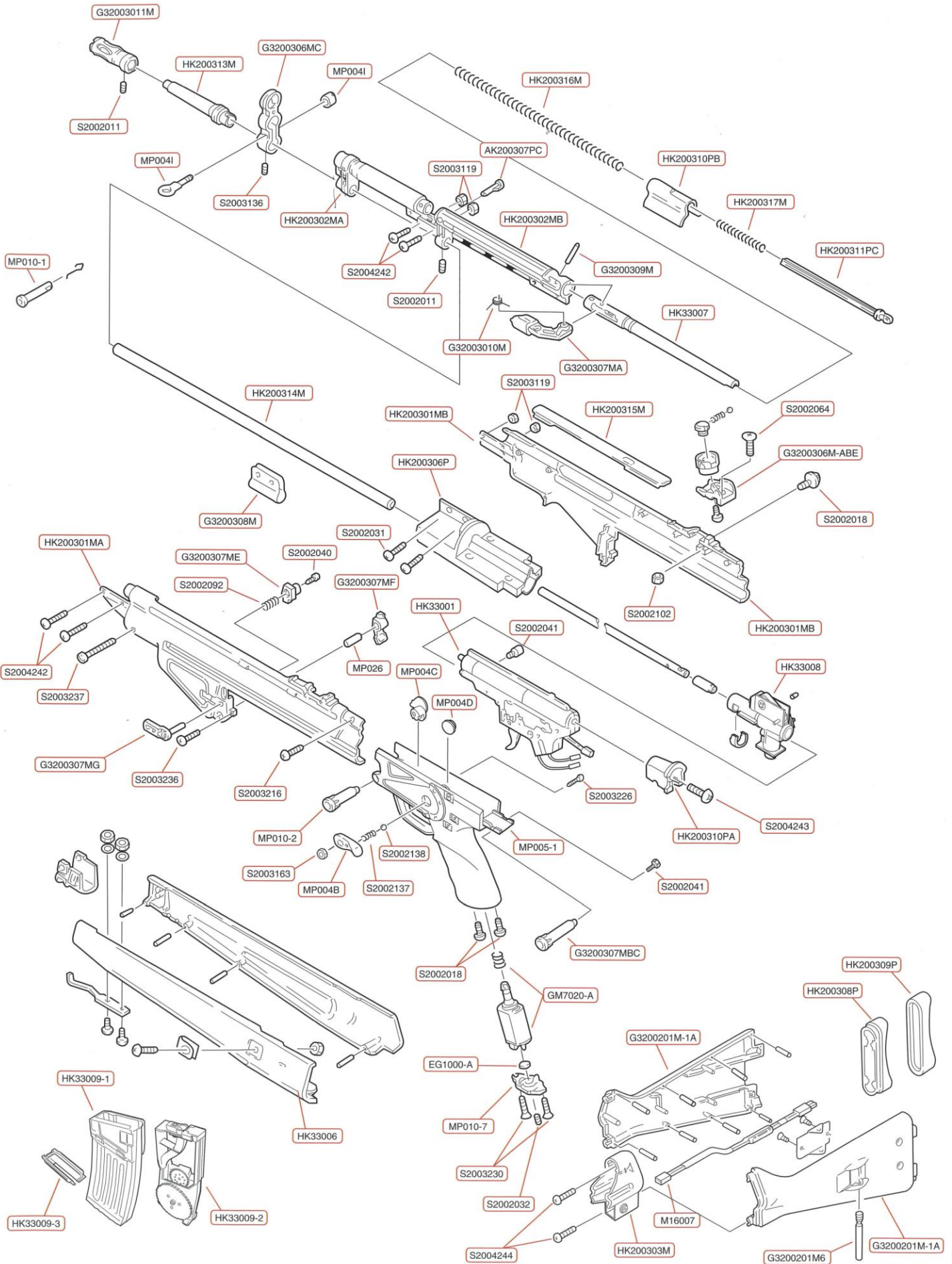

8 Exploded Diagram

