

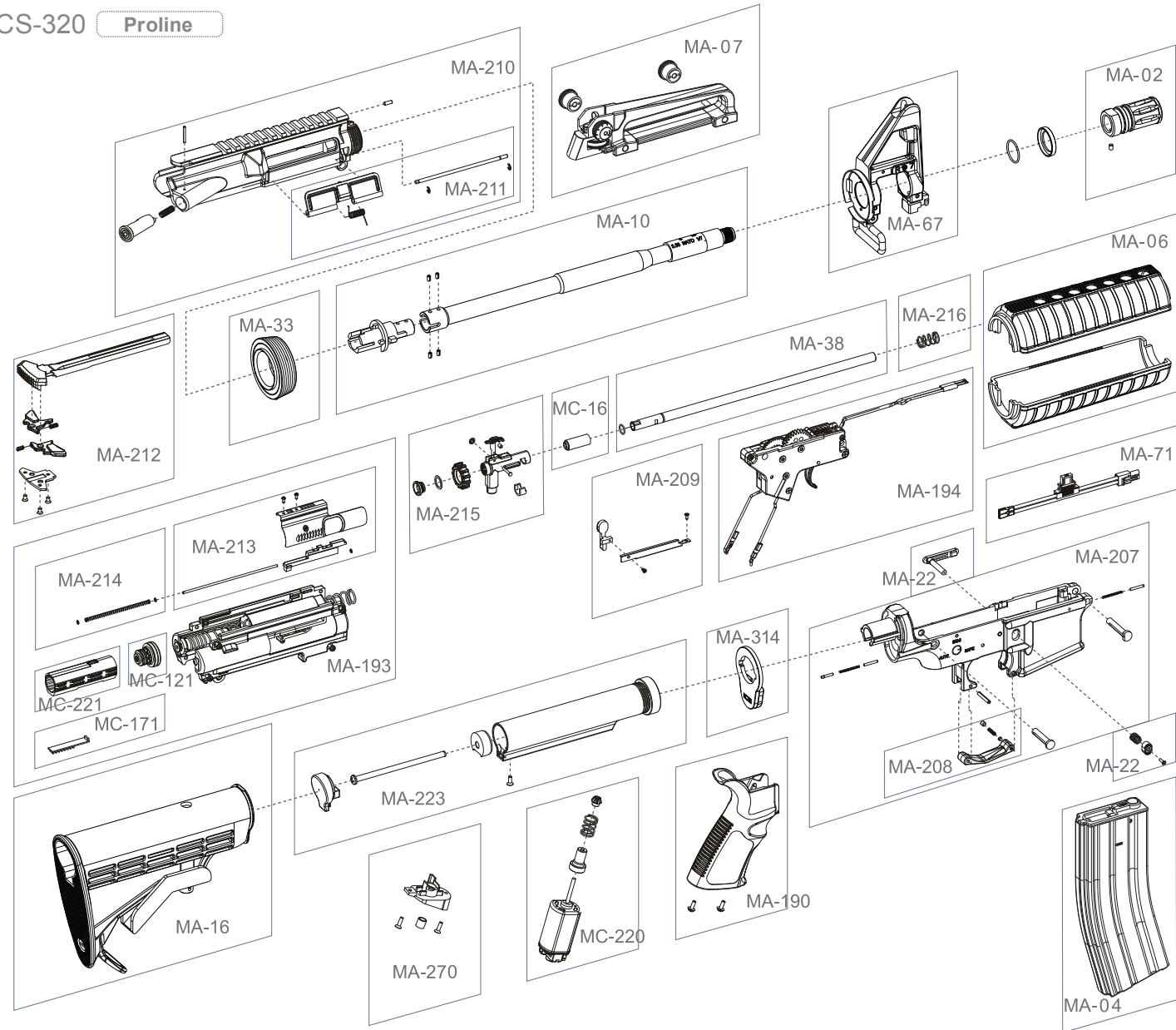

*每一款槍型基本配備不同依實際出貨為主。圖片僅供參考。
The components/accessories for each model may have kind of differences depending on the actual goods. Images are only for reference.

8 各部零件說明 Description

ICS-320 Proline



Patents acquired: US 7077117 B1/R.O.C M244431/R.O.C M320468/ R.O.C. M480664

WARNING 警告 電槍使用之注意事項 Maintenance

- 請勿使用回收及劣質的 BB 彈，以減少槍管損耗與避免卡彈的情形發生。
 - 如發現有卡彈的情形，應立即停止射擊，如卡彈後再勉強射擊，則會增加齒輪損耗。請使用內附通槍條，將卡彈清除後才可繼續使用。若完成通槍基本故障排除後仍無法使用時，請回原採購店家或專業經銷商尋求維修服務。
 - 使用前請先確定您的電池已充滿電，當使用中發覺電池即將用盡或射擊速度降低時，應立即更換電池。
 - 請定期使用通槍條清潔槍管，以保持槍支射擊時的準確性及減少卡彈的情形發生。
 - 請勿經常空槍射擊，以減少BOX及齒輪不必要的損耗。
- Do not use recycle or low quality BB pellets to reduce the barrel damage and prevent from jams.
 - When a BB pellet is jammed, cease fire immediately. Firing under jam may cause damage on gears. Please use the cleaning rod that came with your airsoft gun to push it into the barrel by moving down gently until the jammed BB pellet comes out. If the jam still cannot be solved, please contact your original purchase retailer or ask for professional agent for repair service. Note: No need to remove the barrel when eliminating jam.
 - Please make sure the battery is fully charged before using. When the battery is run out or firing speed is decreasing, new battery has to be replaced immediately.
 - Please use cleaning rod periodically to clean the barrel to ensure the firing precision and reduce jam.
 - Do not dry fire the airsoft gun at any time to reduce damage to the gearbox.

使用前請務必詳閱此說明書限18歲以上使用
Always read through this manual before operation.
User restricted to 18 years of age or older.



www.icsbb.com

一芝軒企業有限公司
I CHIH SHIVAN ENTERPRISE CO., LTD.
TEL:886-4-25256461 FAX:886-4-25256484



1 M4A1 系列各部名稱 M4A1 Series components

ICS-320 Proline



註：若您的電槍採用M100或以下規格的彈簧(初速低於360FPS或110m/s)，僅可使用電壓低於7.4V Li-Po或9.6V Ni-Mh的電池。
Note: For AEG with M100 or below spring setting (velocity setting below 360FPS or 110m/s), it is recommended to use voltage 7.4V Li-Po or below 9.6V Ni-Mh batteries only.

2 彈匣使用方式 Magazine attachment

2-1 裝BB彈方式 Load BBs

將彈匣上蓋依箭頭方向推開再倒入BB彈。
Open the cover to load BBs.

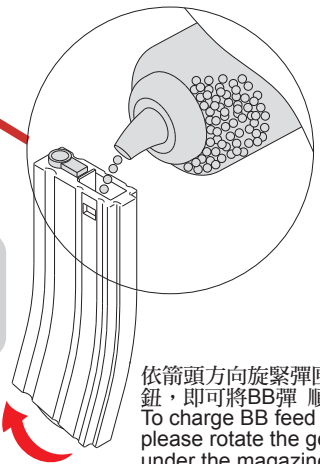

建議使用 ICS 6mm BB彈
ICS 6mm caliber BBs are recommended for optimum performance.

依箭頭方向旋緊彈匣底下旋鈕，即可將BB彈順利送出。
To charge BB feed spring, please rotate the gear under the magazine.

2-2 裝卸彈匣 Magazine Loading and Unloading

直接將彈匣插入槍身彈匣插槽；
按下彈匣釋放鈕以卸除彈匣。
Directly insert magazine into magazine slot; unload the magazine by pressing the magazine catch button.

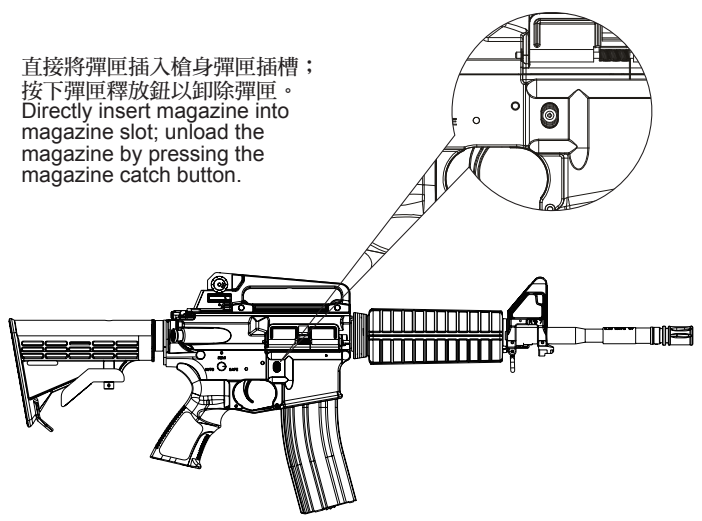

3 可動部的說明 Movable parts

3-1 扳機護弓 Trigger Guard

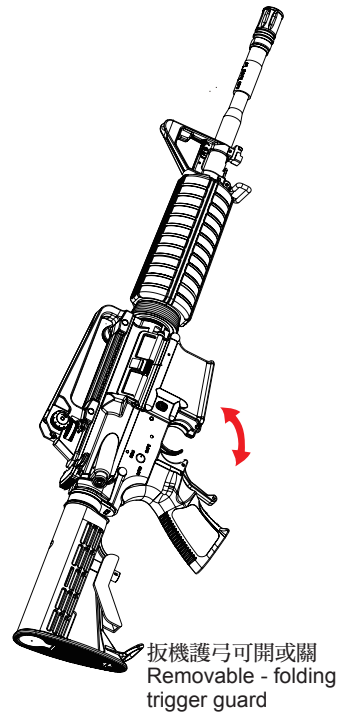

3-2 槍身結合 3 號齒正確位置圖 The correct position of sector gear before reassembling

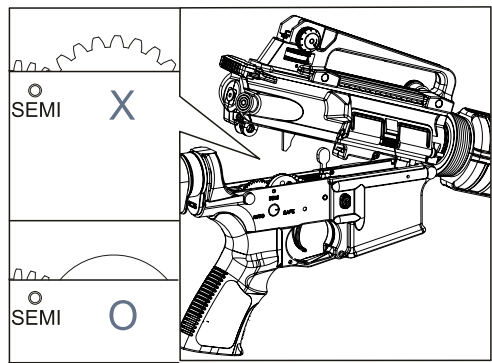

3-4 馬達間隙調整 Motor Gap Adjustment

使用4mm六角扳手來進行馬達齒間隙調整 (出廠前已調整好)。
Use 4mm Allen key to wake the fine-tune adjustment. (Adjust when needed. Already made before out of factory)

3-3 調整伸縮托長度 Adjust Retractable Stock Length

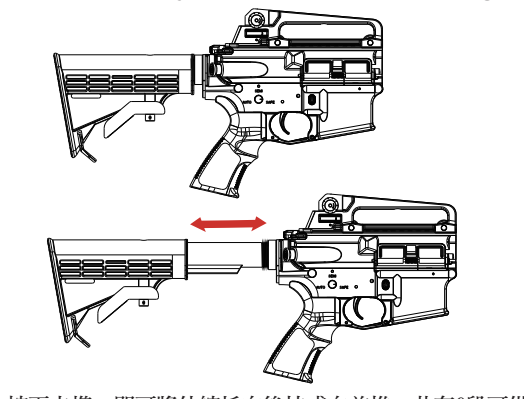

4 調整視孔準星 Sights adjustment

4-1 視孔左右調整 Rear sight left-right adjustment

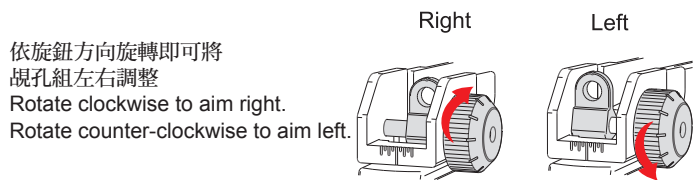

4-2 視孔高度調整 Rear sight up-down adjustment

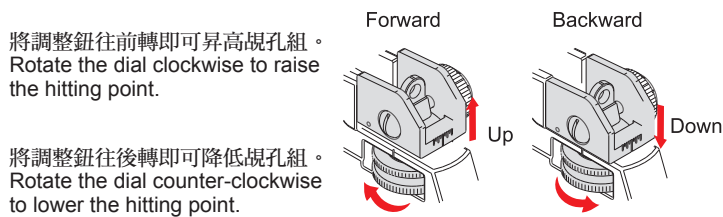

4-3 精密射擊調整 Rear sight precision targeting adjustment

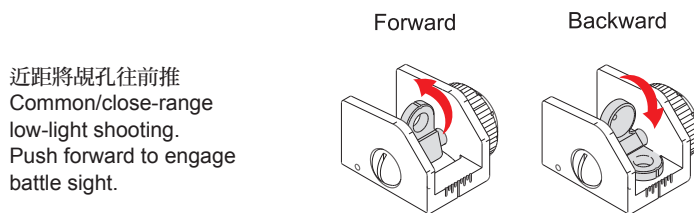

4-3 選擇射擊模式 Shooting Mode Setting

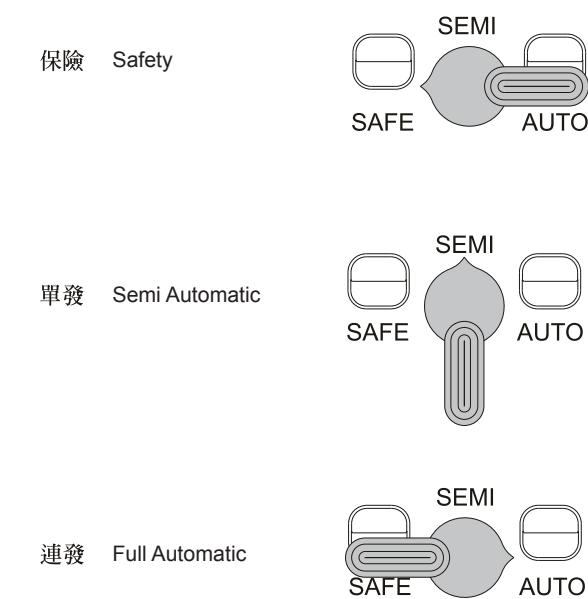

保險與止逆轉釋放同步
Switch the selector lever to safety position (aim forward) can release the spring and cease fire synchronously.

1. 槍枝使用完畢轉至單發狀態下發射2~3下後再關保險，可將活塞彈簧回覆至原處。
2. 槍身做分解時，必須先釋放活塞彈簧，才可做分解動作。

1. After playing, fire 2-3 by using semi automatic, then switch the selector lever to safety position to release the spring tension before storage.
2. Before disassembling the gear box, always release the spring by turning selector lever to safety position.

5 HOP-UP彈道調整 Hop-up adjustment

1. 調整HOP向上使子彈下降
1. Rotate the dial counter-clockwise to make the pellet go down.
2. 調整HOP向下使子彈上升
2. Rotate the dial clockwise to make the pellet go up.

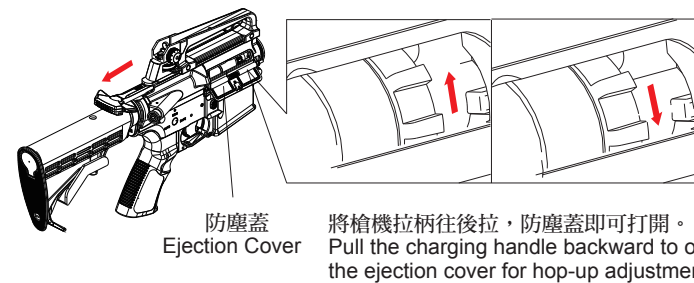

HOP-UP調整：
子彈過於上飄，請調整HOP-UP環向上旋轉。子彈過於下墜，請調整HOP-UP環向下旋轉。BB彈呈現一直線的彈道才是正確射法。

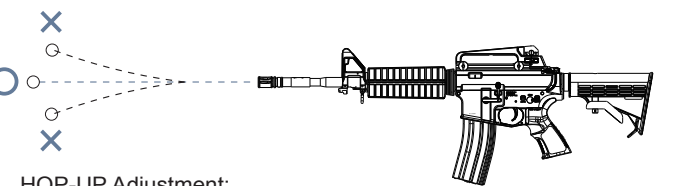

6 電池及護木的拆裝方法 Batteries and handguard installation

注意 CAUTION ※重新組裝時，必須依反向動作組合
Reassembling is the reverse of disassembling procedures.

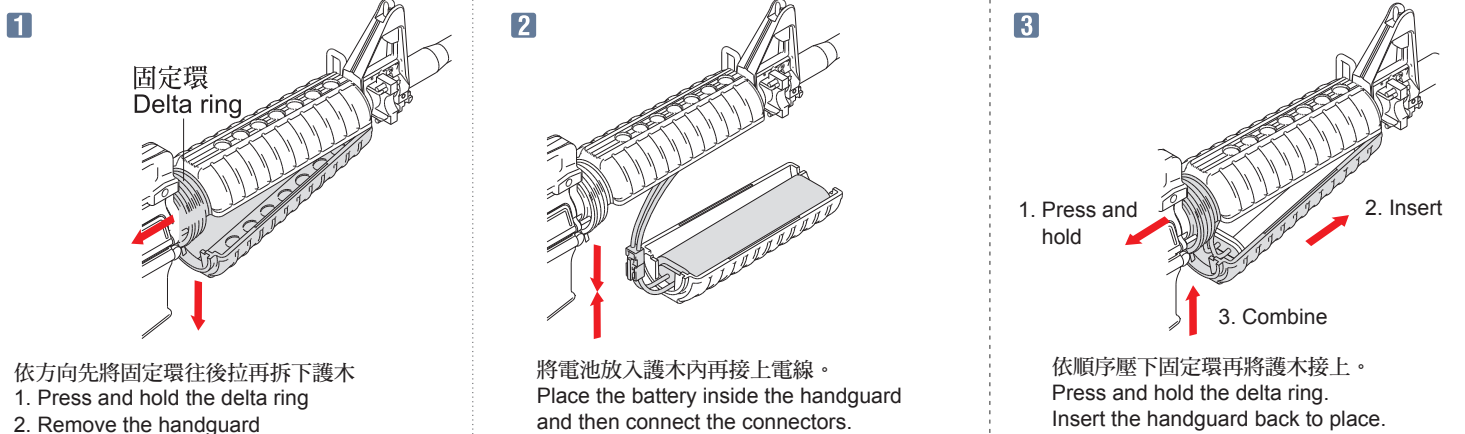

7 齒輪箱拆解 Disassemble gearbox

