

Please read the [Instruction Manual] carefully and make full understanding of the details noted in the contents before use.

WARNING

- To avoid damaging the product, please release the gas from the magazines or cartridges while not operating.
- Sales and usage are restricted to 18-year-old people or older. Those below 18 years old are not allowed neither to purchase nor to operate alone.
- Never aim or shoot at people or animals. Please beware of childrens' mis-handling.
- Please read and fully understand all details listed in this instruction manual before using this air gun. You can download it from www.icsbb.com if you lose this instruction manual.

6mm BB



1 PART DESCRIPTION

WARNING-ATTENTION

This model is featured with Gas-Blow-Back function. The slide will be pushed back and forth by the gas pressure strongly and rapidly while firing. To prevent injury, please keep your face and finger away from the slide.

- The pistol could be damaged when using at temperature of 35°C (95°F) or above.

2 SAFETY DEVICE

Safety ON
Please engage the safety while not operating.

Safety OFF
Disengage the safety when you are going to fire.

- You will not be able to fire when you pull the trigger without pressing the grip safety.
- You will be able to fire when you pull the trigger and press the grip safety firmly.

3 LOADING MAGAZINE

WARNING-ATTENTION

- To prevent misfiring, keep your finger off the trigger and out of the trigger guard while loading the magazine.
- For safety reason, please remove the magazine while not operating.

Load the magazine until it clicks into the locking position.
* Do not insert the magazine by force.

Release the magazine by pressing the magazine catch button.
* Hold the magazine when releasing it from the pistol grip to prevent it from dropping.

4 CHARGING GAS

Please turn the magazine up side down to keep the injection hole side up, fill the gas only when the canister is verticalized to the injection hole.
* The gas will not be filled into the magazine or will leak out if the canister is not verticalized to the injection hole.

Precautions while filling:

- If you fill the magazine with a non-vertical way from up towards down, and caused the magazine is not completely filled, please deflate the gas completely, and refill the gas one more time as instructed.
- Fill the gas until the gas starts to leak out. When the gas is fully filled, gas inside the gas canister and magazine are balance without refilling anymore. It is the normal condition that the gas starts to leak out because it is not able to keep filling. Please stop filling immediately.
- Please use your magazine under normal temperature!
- If operating in environment of 20°C or below, the gas pressure will drop and might cause abnormal functions. (The magazine will work normally again when temperature returns to normal temperature.)
- If operating in environment of 35°C or above, the gas pressure will be too high and might cause abnormal functions. (The magazine will work normally again when temperature returns to normal temperature.)
- If you fill the magazine with gas and fire dozens of shots even under normal temperature, the gas pressure will also drop and cause the gas temperature to drop. Preparing several spare magazines for exchange is recommended.

WARNING-ATTENTION

- Please avoid to touch the injection hole. It might cause frostbites or low temperature burns if the skin is adhered by the gas.
- To preserve the magazine
- Magazines are very delicate parts. Dropping them may cause damage or abnormality.
- Please avoid foreign matter remains on the magazine lip and injection hole on the magazine, which may cause abnormality.
- If refilling is necessary, please avoid to proceed when the magazine is loaded. Please unload the magazine before proceeding.
- Please do not place the magazines in wet or watery places, which may cause abnormality.

5 LOADING BBs

Leave no gap between BBs

WARNING-ATTENTION

- Do not release the magazine follower abruptly while pressing the follower. Releasing the follower carelessly may damage the magazine lip.

Pull the magazine follower down to the end, insert BBs into the BB slot.
* Maxumum 17 rounds

You may insert the last BB through the magazine lip.
* Do not attempt to insert more than 17 BBs.

6 Loading

1. Insert the magazine.
2. Pull the slide to the end and hold (the hammer will be pressed down).
3. Release the slide (the slide is held at the back at the moment).
4. Press the slide catch downward, the slide will be pushed forward (a BB pellet will be loaded into the barrel).

WARNING-ATTENTION

- Keep your face and fingers away from the slide while the slide is operating.
- When the pistol is unloaded, the slide can be pushed forward when you pull and release it from the end.
- When the pistol is loaded, loading repeatedly will makes the BBs load into the barrel repeatedly, which will lead to malfunction while firing and cause danger.
- When the hammer is pressed down, pulling the trigger will fire the BB. Please take extra notice.

7 SHOOTING

1. Switch the safety to FIRE.
2. Load the pistol according to step 6.
3. Pull the trigger to fire (a BB pellet will be fired and the slide will be pushed backward).

The slide will be blown back and forth when firing.

WARNING-ATTENTION

- Power Depression
When the temperature inside the magazine is too low, the gas power will be depressed.
The movement of the slide will be delayed.
The slide catch will not be bounced.
The shooting range will not be far.
- Shooting posture
Please do not operate the pistol up side down for optium performance.

To prevent misfiring, keep your finger off the trigger and out of the trigger guard when you are not ready to fire.

When the BB is loaded into the barrel, the following process will be proceeded and repeat automatically everytime you pull the trigger:
BB fired → Slide movement (blowed backward) → Load the next BB (slide re-positioned)

ATTENTION

- The rails on the slide is very sharp. Please keep your face and fingers away from the slide while the slide is operating.
- Please keep your finger off the trigger and out of the trigger guard, and take extra caution to where the gun is aiming while proceeding non-firing operations.

8 STORAGE

1. Press the magazine catch button to release the magazine.
2. Make sure the inner barrel is clear. If not, pull the slide backward, and turn the pistol up side down to remove the remaining BB, make sure no BBs are left inside the barrel. (push the BB pellet out from the barrel by the clearing rod is recommended).
3. Press the slide catch lever to release the slide.
4. Pull the trigger and fire several times towards safety directions, and make sure no BBs are left inside the barrel.

9 DISASSEMBLY (Do it when necessary)

Only disassemble your airsoft replica when adjusting the H-UP and proceeding to maintenance.

- Press the magazine catch button to unload the magazine.
- Pull and hold the slide to the end.

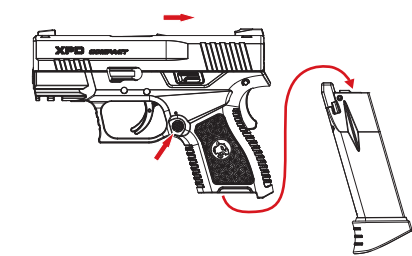

- Push the slide catch lever upward to hold the slide at the rear.
- Turn the slide release button upward to head 12 o'clock direction, hold your slide with your hand then press the slide catch lever.

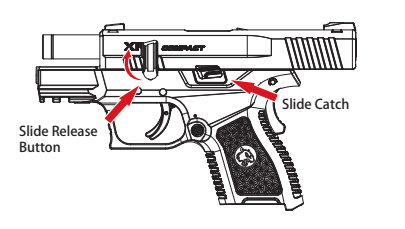

- Push the slide forward to remove.

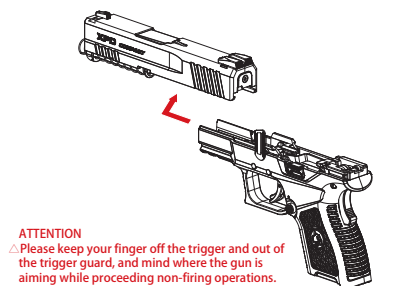

ATTENTION
Please keep your finger off the trigger and out of the trigger guard, and mind where the gun is aiming while proceeding non-firing operations.

- Push the recoil spring guide forward to detach from the slide, then remove it upward.
- Slightly push the outer barrel assembly forward, and then remove it upward.

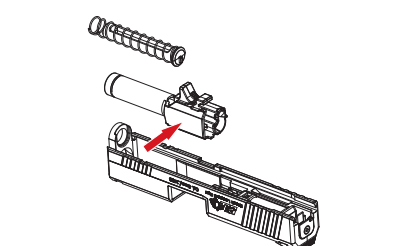

10 H-UP ADJUSTMENT

- Please disassemble and remove the slide as step 9 instructed.
- Slightly rotate the dial to adjust the H-UP.

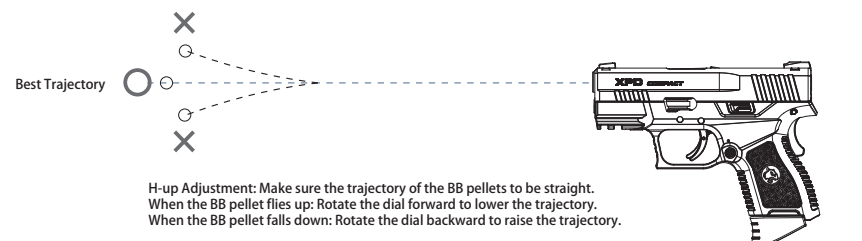
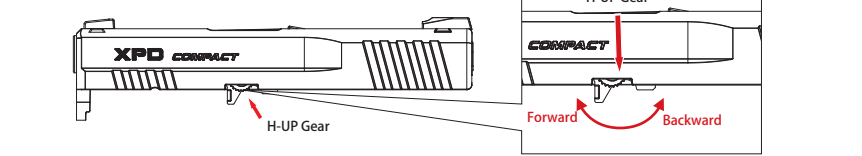

H-up Adjustment: Make sure the trajectory of the BB pellets to be straight. When the BB pellet flies up: Rotate the dial forward to lower the trajectory. When the BB pellet falls down: Rotate the dial backward to raise the trajectory.

11 ASSEMBLY

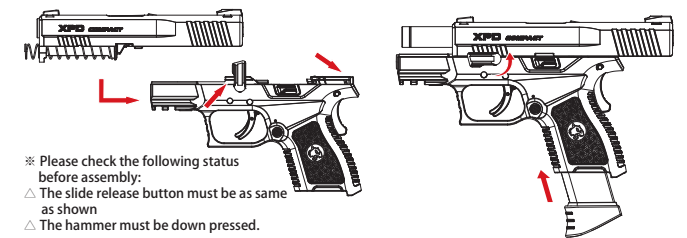

WARNING · ATTENTION

ICS will not be responsible for any part assembling errors, missing parts, and problems such as malfunctions, accidents, injuries, caused by malfunction, and all the maintaining expenses will be beared by the customer themselves.

- ※ Please check the following status before assembly:
 △ The slide release button must be as same as shown
 △ The hammer must be down pressed.
- Insert the slide back to the receiver through the rail from the front.
 - Push and hold the slide to the end.

- Turn the slide release button back to its horizontal position, then release the slide.
- Load an empty magazine.

12 BASIC TROUBLESHOOTING GUIDE

SYMPTOMS	POSSIBLE CAUSES	SOLUTIONS
No Response	The safety is ON. (No firing)	Switch the safety to "OFF" (refer to step 2)
	Magazine overpressured.	Press the valve gently to release gas and to adjust pressure. Be careful when gas is discharged from the nozzle seal.
	Insufficient gas inside the magazine.	Charge gas into magazine (refer to step 4)
The slide blows back but no BB is fired.	BB can't be loaded into the barrel.	Load the first BB into the barrel (refer to step 6)
	BB is jammed inside the magazine.	Push out the BB by using the clearing rod, or pulling the slide backward, and turn the pistol up side down to remove.
	Magazine is too cold.	Use the magazine after it is returned to normal temperature (refer to step 4).
Temperature is too low.		
Will not complete cycle	Magazine is too cold.	Use the magazine after it is returned to normal temperature (refer to step 4).
	No gas in the magazine.	
	Lubricant or silicon oil is not enough.	Apply lubricant to the moving aptrts.
Slide jammed	BBs or foreign matters jammed inside the slide or frame.	Remove the BBs or foreign matters.
	Slide stop is in the locking position.	Pressing down the slide stop to free the slide.
	Gas comes out from the barrel	Use the magazine after it is returned to normal temperature (refer to step 4).
Temperature is too low.		
BBs fly up	H-UP is over adjusted.	Adjust the H-UP gear forward.
	H-UP isn't adjusted enough.	Adjust the H-UP gear backward.
Shooting range is too short	Foreign matters or oil in the inner barrel.	Clean the inner barrel and H-UP bucking.
	H-UP isn't adjusted enough.	Adjust the H-UP gear forward.
BBs roll out of barrel	H-UP is over adjusted.	Adjust the H-UP gear backward.
	Bad BBs, oversize BBs	0.2g to 0.25g 6mm caliber BBs are recommended for optimum performance.
	Foreign matters or oil in the inner barrel.	Clean the inner barrel.
Jammed	H-UP is over adjusted.	Adjust the H-UP gear backward.
	H-UP isn't adjusted enough.	Adjust the H-UP gear forward.

13 PARTS DIAGRAM

*The components/accessories for each model may have kind of differences depending on the actual goods. Images are only for reference.

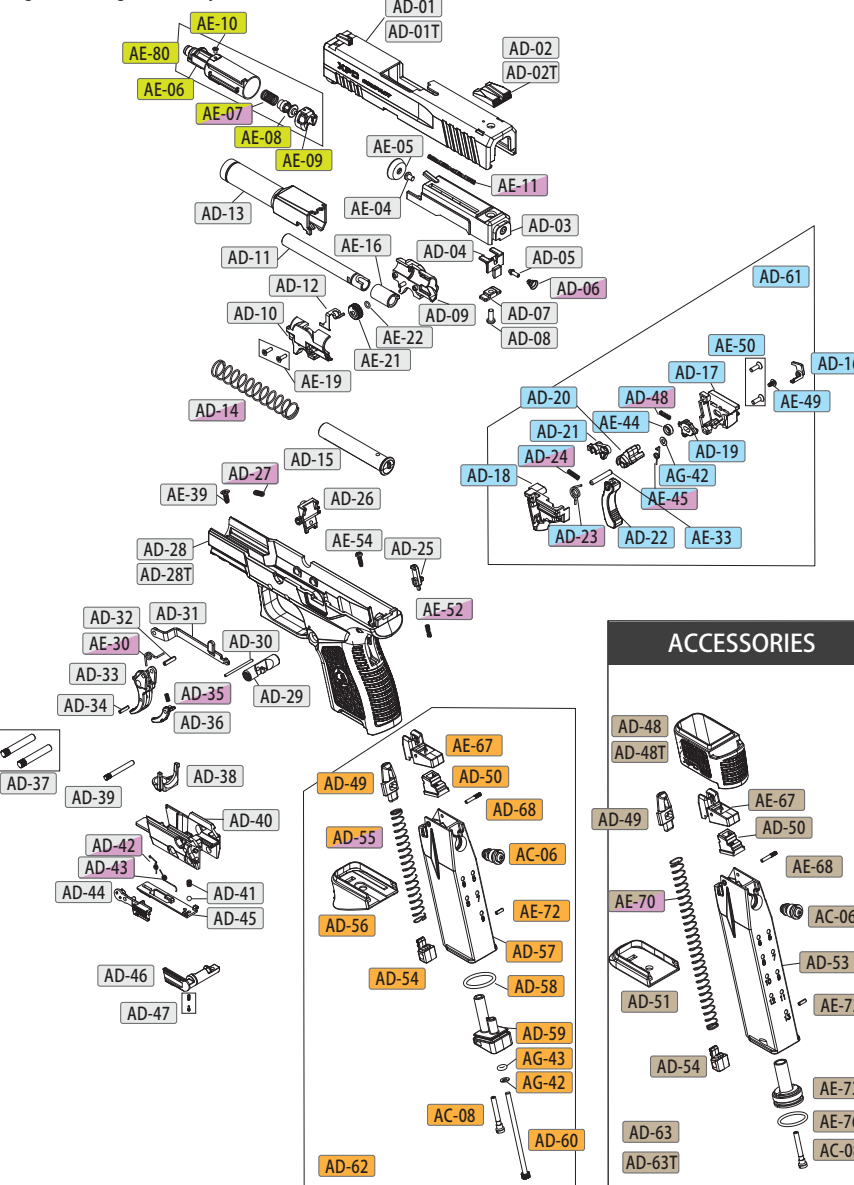

14 PARTS DESCRIPTION

ITEM#	DESCRIPTION	Q'TY	ITEM#	DESCRIPTION	Q'TY
AD-01	XPD Slide with Front Sight-BK	1	AD-49	XPD Magazine Follower	1
AD-01T	XPD Slide with Front Sight-TAN	1	AD-50	XPD Magazine Nozzle Seal	1
AD-02	XPD Rear Sight-BK	1	AD-51	XPD Extended Magazine Base	1
AG-02T	XPD Rear Sight-TAN	1	AD-53	XPD Extended Magazine Case	1
AD-03	XPD Cylinder Housing	1	AD-54	XPD Magazine Base Plate Stop	1
AD-04	XPD Loaded Chamber Indicator Housing	1	AD-55	XPD Short Magazine Follower Spring	1
AD-05	XPD Loaded Chamber Indicator	1	AD-56	XPD Short Magazine Base Plate-BK	1
AD-06	XPD loaded Chamber Indicator Spring	1	AD-57	XPD Short Magazine Case	1
AD-07	XPD loaded Chamber Indicator Mount	1	AD-58	XPD Magazine Base O-Ring	1
AD-08	Cylinder Housing Screw	1	AD-59	XPD Magazine Base	1
AD-09	XPD H-UP Chamber-Right	1	AD-60	XPD Magazine Base Screw	1
AD-10	XPD H-UP Chamber-Left	1	AD-61	XPD Hammer Combination	1
AD-11	XPD Inner Barrel (7.5mm)	1	AD-62	XPD Short Magazine	1
AD-12	XPD H-UP Plate	1	AD-63	XPD Extended Magazine-BK	1
AD-13	XPD Outer Barrel	1	AD-63T	XPD Extended Magazine-TAN	1
AD-14	XPD Recoil Spring	1	AD-64	XPD Spring Parts	1
AD-15	XPD Recoil Spring Guide	1	AE-04	M1 Screw	1
AD-16	XPD Hammer Insurance Lever	1	AE-05	XAE Valve Plate	1
AD-17	XPD Hammer Housing-Right	1	AE-06	XAE Cylinder	1
AD-18	XPD Hammer Housing-Left	1	AE-07	XAE Valve Spring	1
AD-19	XPD Hammer Disconnecter	1	AE-08	XAE Valve	1
AD-20	XPD Hammer	1	AE-09	XAE Cylinder Cover	1
AD-21	XPD Hammer Bar	1	AE-10	Cylinder Screw	1
AD-22	XPD Grip Safty	1	AE-11	XAE Cylinder Housing Spring	1
AD-23	XPD Hammer Spring	1	AE-16	XAE H-UP Bucking	1
AD-24	XPD Grip Safty Spring	1	AE-19	XAE H-UP Chamber Screw	2
AD-25	XPD Hammer Disconnect Pin	1	AE-21	H-UP Dial	1
AD-26	XPD Magazine Catch	1	AE-22	O-ring	1
AD-27	XPD Magazine Catch Spring	1	AE-30	XAE Trigger Bar Spring	1
AD-28	XPD Frame-BK	1	AE-33	Slide Catch Lever Plate Pin	1
AD-28T	XPD Frame-TAN	1	AE-39	Slide Positioning Block Screw	1
AD-29	XPD Magazine Release Button	1	AE-44	XAE Hammer Guide Wheel	1
AD-30	Magazine Catch Pin	1	AE-45	XAE Hammer Bar Spring	1
AD-31	XPD Trigger Bar	1	AE-48	XAE Hammer Disconnecter Spring	1
AD-32	Trigger Bar Spring Pin	1	AE-49	Round Head Hammer Housing Screw	1
AD-33	XPD Trigger	1	AE-50	Flat Head Hammer Housing Screw	2
AD-34	Trigger Safety Pin	1	AE-52	XAE Hammer Disconnect Pin Spring	1
AD-35	XPD Trigger Spring	1	AE-54	Hammer Housing Screw	1
AD-36	XPD Trigger Safety	1	AE-67	Magazine Lip	1
AD-37	XPD Frame Housing Pin	2	AE-68	Magazine Lip Pin	2
AD-38	XPD Slide Positioning Block	1	AE-70	Magazine Follower Spring	1
AD-39	XPD Hammer Housing Pin-Rear	1	AE-72	Magazine Base Plate Stop Pin	1
AD-40	XPD Trigger Housing	1	AE-73	XAE Magazine Gas Tube and Base	1
AD-41	Bearing Ball and Spring	1	AE-76	O-ring	1
AD-42	Slide Disassemble Lever Spring	1	AE-80	XAE Cylinder Combination	1
AD-43	Slide Locking Plate Spring	1	AG-42	Washer	2
AD-44	XPD Slide Catch Lever Plate	1	AG-43	Screw O-Ring	1
AD-45	XPD Safety Plate	1	AC-06	REVO Energy Valve	1
AD-46	XPD Slide Disassemble Lever	1	AC-08	REVO Energy Nozzle	1
AD-47	XPD Slide Disassemble Lever Button and Spring	1			
AD-48	XPD Extended Magazine Grip Cover-BK	1			
AD-48T	XPD Extended Magazine Grip Cover-TAN	1			