

使用說明書

HANDLING CAUTIONS AND INSTRUCTION MANUAL

PDW

KAC PERSONAL DEFENSE WEAPON

CAL. 6 x 35 MM

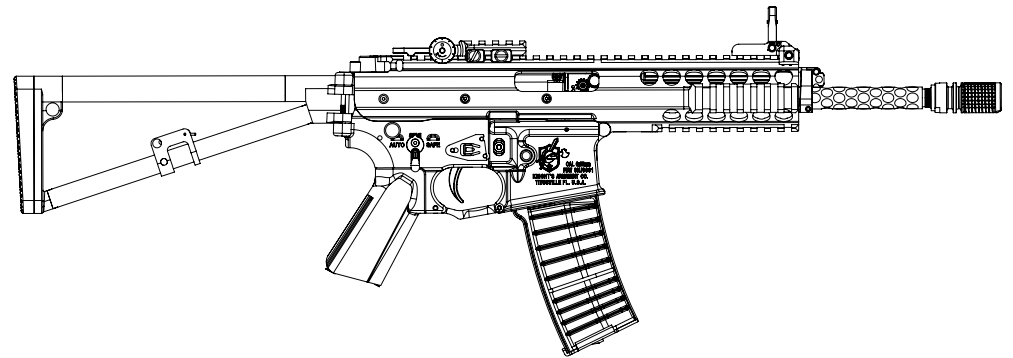

VegaForce Company
<http://www.gb-tech.com.tw>



VegaForce Company
Automatic Electric Rifle

對象年齡十八歲以上 User restricted to 18 years of age or older

4F-6, No.14, Xiwei St., Sanchoung City, Taipei County 241, Taiwan
TEL : 886-2-2287-9427 FAX : 886-2-2287-9450
Email : gb.tech@msa.hinet.net

注意
WARNING

使用前請務必詳讀此說明書
Always read through this manual before operation.

目錄 INDEX

警語
WARNING

- 1** 特色與簡介
PROFILE
- 2** 各部名稱
COMPONENT NAME
- 3** 選擇鈕、手動保險的說明
SELECTOR LEVER & SAFETY SETTING
- 4** 電池的安裝
SETTING BATTERY
- 5** 彈匣的安裝
SETTING MAGAZINE
- 6** 準星與照門的調整
SETTING THE FRONT SIGHT AND REAR SIGHT
- 7** 可動部的說明
MOVABLE PARTS
- 8** 射擊
FIRING
- 9** 可變HOP-UP系統說明
VARIABLE HOP-UP SYSTEM
- 10** 故障內容自我診斷
TROUBLE CLINIC
- 11** 分解圖、零件表
PARTS LIST
- 12** 關於售後服務
AFTER SERVICE
- 13** 相關周邊產品
ACCESSORIES
- 14** 近期發售
COMING SOON

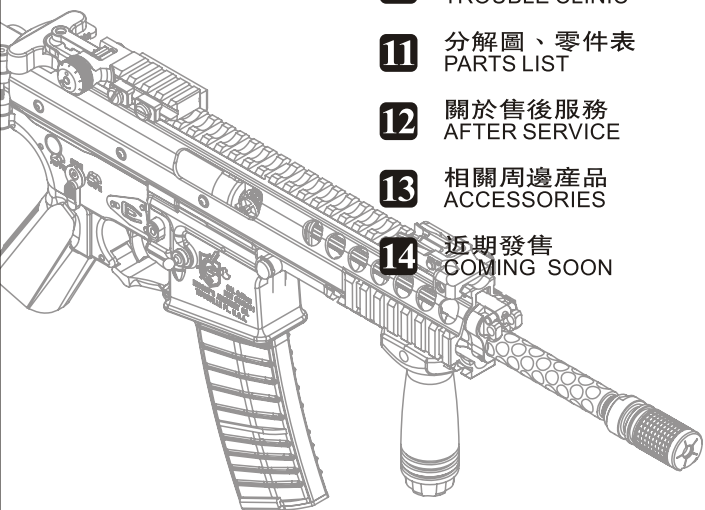

警告

WARNING

- 請務必帶上護目鏡等護眼用具。
- 請勿射擊人或動物。
- 隨意用BB槍開玩笑可能會觸及法律。
- 嚴禁望向槍口。
- 請將槍口朝向安全的地方。
- 射擊時無論遠近，隨時確認射擊區內是否有行人或車輛經過。
- 避免任意不經意地扣處扳機。
- 除非完成射擊準備，否則切勿將手指放入扳機。
- 不用或搬運時，請務必放置於槍盒等容器內。
- 請存放在兒童拿不到的地方。
- 禁止擅自改造或加強槍枝結構。
- 非射擊時請將選擇鈕切換到保險位置。

- Always wear eye protective gear.
- Never aim or shoot a person or animal as the target.
- You may be punished if you are shooting for a practical joke.
- Never look into the gun muzzle.
- Always direct the muzzle towards a safe direction.
- Never shoot the air gun at places where people and cars pass cross.
- Avoid pulling the trigger carelessly.
- Please put away your fingers from the trigger, except when you are Ready to shoot a target.
- Always put the gun in a case or bag when you are carrying it.
- Store the gun at places out of reach by children.

在操作本產品之前，請務必詳讀此操作手冊
Always read through this manual before operation.



PDW CAL. 6 x 35 mm KAC PERSONAL DEFENSE WEAPON

1 PROFILE

The Story of KAC PDW

In mid 80s, US Army developed Personal defense weapon (PDW). It filled a similar role; it was primarily intended not for front line troops, but for others such as drivers, engineers and medics to defend themselves in an emergency. As it give portable, easily control, and penetration to instead of pistol, submachine gun and assault rifle. In 2006, after FN P90, and H&K MP7, Knight's Armament Company (KAC) announced a submachine gun size with assault rifle fire power advanced weapon – KAC PDW.

KAC PDW has two versions, one with 8 inch barrel and the other with 10 inch barrel. The weight is just around 2kg. Its length with butt stock folded is only 17.5inches. It's an ultra lightweight and compact weapon. It fires a 6x35 mm cartridge, and could get an effective range in 300M to penetrate the body armour. It has two gas pistons tapping hot gas from the barrel to operate its mechanism, located on the top left and right sides of the bolt carrier. The single mainspring is located on top, between the two gas pistons. The bolt itself is said to be similar to an AK-47-type rotating bolt. The specialist looks is the concave circular hole on the barrel surface to reduce the weight and heat. The particular configuration of flash hider is stock plate inside design to suppress the barrel bound up from the fire. The upper receiver integrates the rail hand guard and equips a removable flip up front sight and rear sight. The lower receiver is similar to M4 series; charging handle, magazine catch, bolt catch and selector lever...etc are also as the same as M4 series. Therefore, M4 user will use this gun very easier.

With compact size, amazing fire power, easy control and high penetration...etc features, the KAC PDW already becomes a rising star in the world of advanced weapon. Surely, the intelligence such as TSWG make the best choice to choose KAC PDW.

Profile of VFC KNIGHT PDW

Always pursues the innovation, and keep the fineness, and realism as a faith, the VFC paid a lot of effort and cost to develop such an advanced weapon KAC PDW to an outstanding AEG.

The VFC Knight PDW is made from high quality aluminum alloy and steel, and process with CNC machining and military standard finish. The resulting product has the exact look and feel of the real steel. The many metal components of the PDW give it a solid but well balanced, easily maneuverable feel. Every detail of externals, including the concave circular holes barrel, grenade surface liked flash hider, and one peace upper receiver...K.etc, is meticulously crafted. The unique patented design such as the Bolt Lock System and functional ambidextrous safety, and magazine catch, upgrade the maneuverability.

Regarding the gearbox mechanism, it equips 8mm enhanced precision Gear-Box, with professional steel bushing, high hardness steel gears, durable Polymer Carbon piston which material is also the same as the Glock pistol frame, and ball bearing spring guide. It is strictly tested by the 12 volt Car Battery and suit for the Li-Poly battery. The instant you pull the trigger, you will feel the amazing explosive force.

VFC Knight PDW represents the KAC knight spirit successfully, and satisfies the players' ultimate aspiration. With remarkable configuration and excellent performance, it would be the first choice of CQB AEG.

PDW CAL. 6x35 MM KAC PERSONAL DEFENSE WEAPON

1 KAC PDW 實槍簡介

特色與簡介

80年代中期，美軍提出「個人防衛武器」（簡稱PDW）的概念，針對後勤單位、駕駛員、工兵等非一線的作戰單位，裝配輕便且容易瞄準操作，同時能有效貫穿敵人防彈衣的小型火器，以取代手槍、衝鋒槍及短突擊步槍。針對這樣的需求，在FN P90、HK MP7等PDW相繼問世之後，2006年，奈特軍火公司（簡稱KAC）也正式公開了有著衝鋒槍尺寸，步槍火力的先進武器-KAC PDW。

KAC PDW分為八吋管與十吋管兩種版本，重量約兩公斤左右，槍托摺疊後的長度僅17吋，非常的輕巧緊緻。而它採用6mmx35的特殊彈藥，射程可達300公尺，具備足夠的殺傷力可穿透防彈衣。內部採用雙活塞導氣式系統，複進簧位於兩組導氣活塞之間，由機匣前端一直延伸到尾部，槍機系統則是採用AK方式的迴轉式閉鎖槍機系統。外型最特殊之處，莫過於槍管上滿佈圓形凹孔，用以減輕重量與散熱。特殊構型的防火帽，內有擋板設計，配合表面數百個氣孔，可有效抑制槍口上揚。上機匣與前段軌道護木為一體成型，上有可拆式折疊準星及照門。而下機匣原則上與M16/M4相似，在槍機拉柄、彈匣卡榫、槍機卡榫及射擊選擇鈕等操作介面則與M16/M4完全相同。因此，M4的使用者可以快速熟悉這把槍。

由於KAC PDW的輕薄短小，火力驚人，容易操控，再加上極佳的穿透力，無異是先進武器中的明日之星，也難怪美國最神秘的技術支援工作小組TSWG等情治單位已率先使用。

VFC Knight PDW 電槍簡介

一向追求創新的VFC，投注大量的心力與成本，秉持著超高細緻度與極致像真度的信念，務必將這把走在時代尖端的先進武器KAC PDW完美電槍化。

在材質方面，嚴選高級的鋁合金與鋼材，輔以精密的CNC機械銑削，加上軍規等級的表面，顯現出凌駕真品的質感。整把槍因採用大量的金屬而顯得堅固扎實，但講究高度的平衡手感，因此不失輕巧靈活。而外觀各個細節，包括滿佈球狀凹穴的槍管，宛如破片手榴彈外表的防火帽，以及一體式的上機匣等，全都一絲不苟的忠實呈現。而延續前做特殊專利設計的槍機後定功能，及雙邊連動保險、雙邊連動彈匣卡榫等機構也大幅提升整把槍的操控性。

內部機構方面，8mm強化型高精度齒輪箱，採用專家級鋼製軸承，高硬度鋼製齒輪，與真品GLOCK同級的PC塑料製成的超耐磨強化活塞，並搭配滾珠培林尾頂桿，歷經12V汽車電瓶嚴格的測試，可使用鋰電池，在扳機扣動的瞬間，即可感受到其驚人的爆發力。

VFC Knight PDW成功詮釋了KAC的騎士精神，滿足玩家們求真求善的極致需求。配置超凡，性能卓越，堪稱CQB電槍的第一選擇。

八吋版 / 十吋版 8" / 10"	KAC PDW	VFC KNIGHT PDW AEG
口徑 CAL	6mm X 35	6mm BB
全長 OVERALL	8" barrel 17.5/26 inch 10" barrel 19.5/28 inch	8" Barrel 442/665 mm 10" Barrel 491/718 mm
槍管長 BARREL	8 inch / 10 inch	8 inch / 10 inch
重量 WEIGHT	4.3 / 5.1 pound	2350 / 2390 g
裝彈數 CAPACITY	30 rounds	120 rounds
槍口動能 VELOCITY	2425 fps (about 1150J)	98 m/s (about 0.96J)



2 各部名稱

Right Side

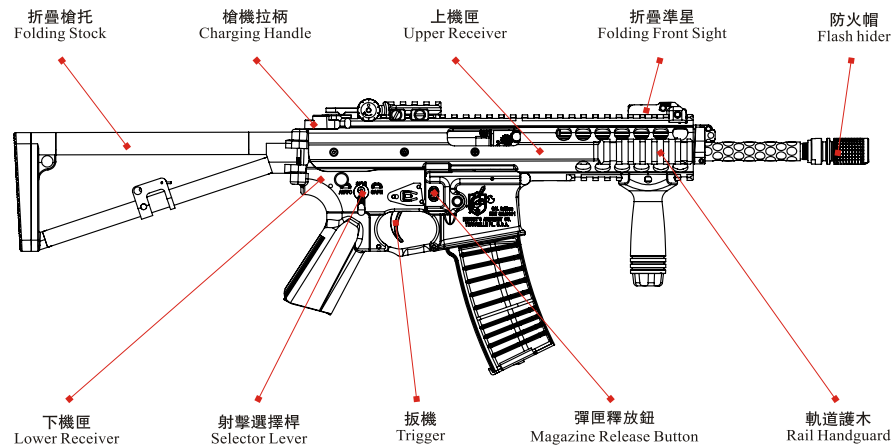

Left Side

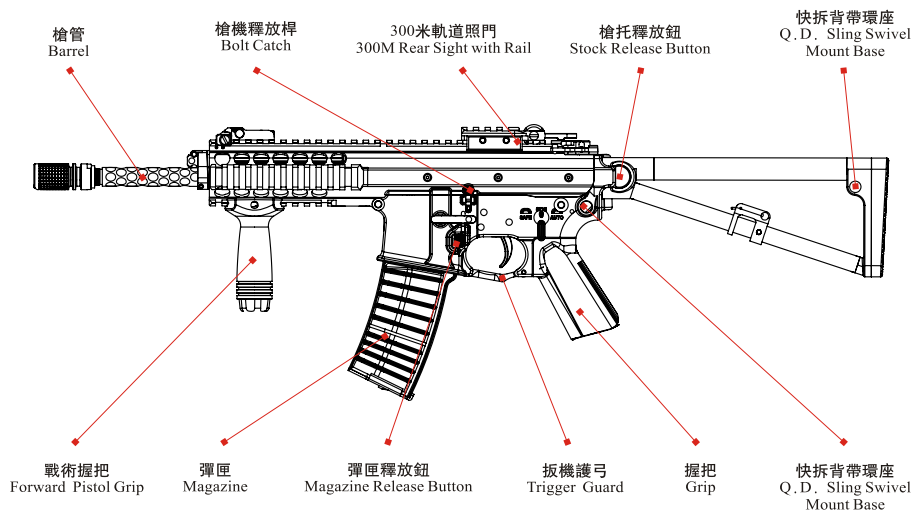

3 選擇鈕、手動保險的說明

※選擇鈕未扳至正確位置有可能會導致射擊模式發生錯誤。
 ※Be careful not to catch your fingers in the moveable parts.

Right Side 右側

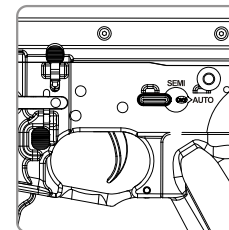
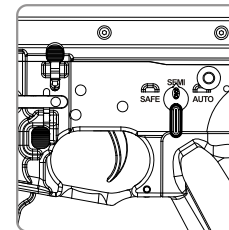
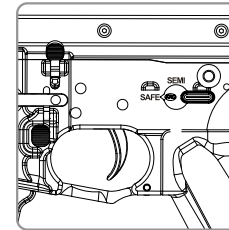

Left Side 左側

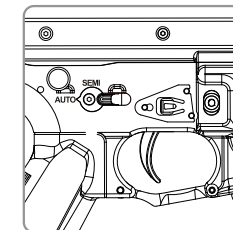
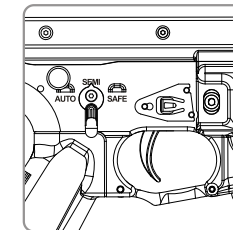
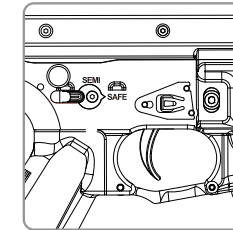

保險(無法扣動扳機)
 不射擊或一般存放時,務必將選擇鈕設定至保險位置。

Safety Setting
 (The trigger can not be pulled)
 Always set the lever to the Safety position when you are not firing the gun or during storage.

半自動(單發)
 扣一次扳機只會發射一顆子彈。

Semi Auto
 (Single Shot)
 The gun will fire one shot each time the trigger is pulled.

全自動(連發)
 扣著扳機不放會連續發射子彈。

Full Auto
 (Automatic Shot)
 The gun will fire automatically while the trigger remains pulled.

警告・注意

- 請勿一邊扣動扳機一邊扳動選擇鈕,否則將導致動作不良或發生意外。
- 在關保險狀態,強制扣動有可能會導致故障。

WARNING・CAUTION

- Never operation the Selector while pulling the trigger. Otherwise, malfunctions are possible, resulting in accidents.
- Pulling the trigger with the Selector being set to safe may damage the gun.

4 電池的安裝 *Setting the Battery*

- ※電池必須先行充電完畢。
- ※安裝電池前先卸下彈匣。
- ※Conduct operations hereafter charging the battery
- ※The magazine is done under the condition that is removed.

- 轉下電池盒蓋旋鈕。
Turn the cap screw counterclockwise to detach it.
- 打開電池盒蓋。
Open the cap.
- 塞入電池並將電池盒蓋裝回。
Insert the battery and close the cap.

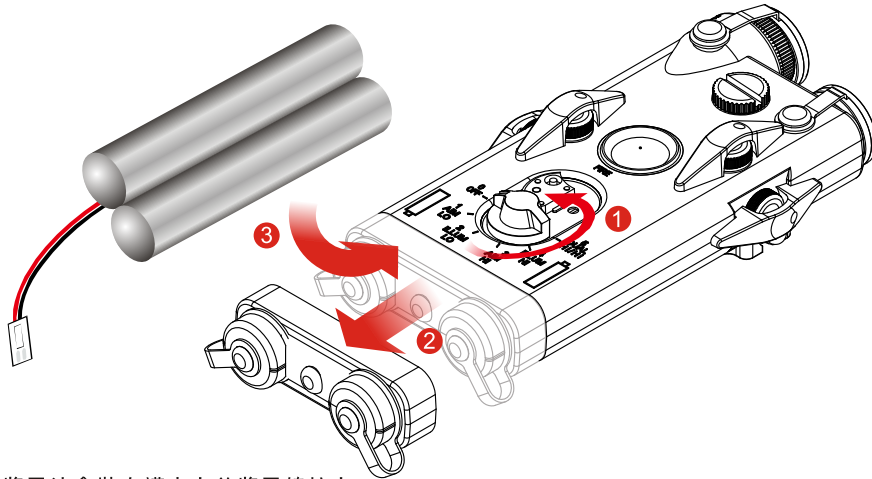

- 將電池盒裝在護木上並將電線接上。
Install the battery box on the hand guard, then connect the connectors.

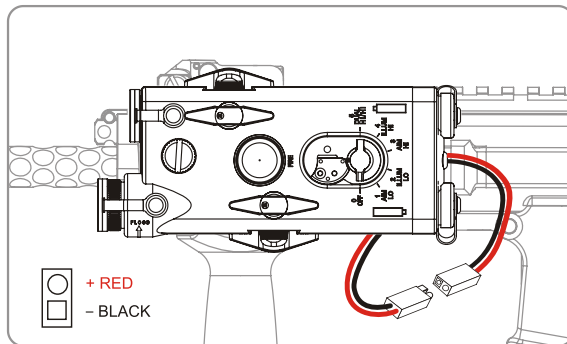

警告 · 注意

- 電池安裝時，請將槍口朝向安全的位置，並將選擇鈕設定於保險位置。

WARNING · CAUTION

- Direct the muzzle towards a safe direction and set the selector lever to the Safety position.

5 彈匣的安裝 *Setting the Magazine*

- ※可使用PDW專用彈匣或M4系列彈匣。
- ※You can use the PDW type magazine or the M4 series magazine.

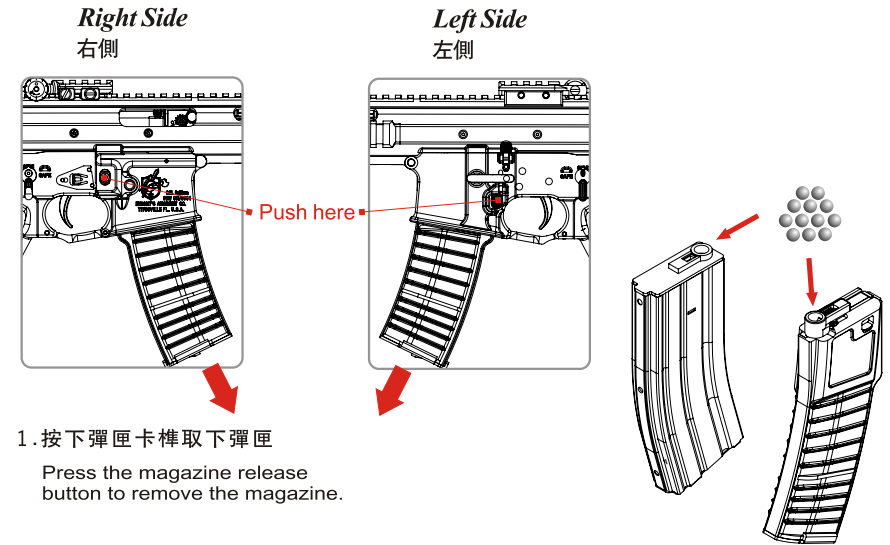

- 按下彈匣卡榫取下彈匣
Press the magazine release button to remove the magazine.

- 將6mmBB彈裝填入彈匣，PDW專用彈匣最大容量為120發
Insert 6mm BB bullets into the magazine.
The MAX capacity of PDW type magazine is 120 rounds.

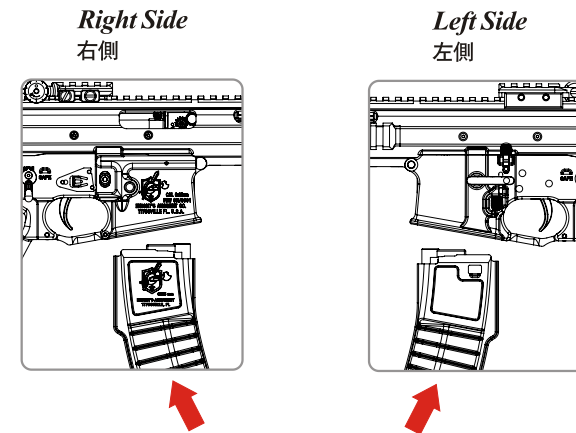

- 垂直插入彈匣並確認彈匣卡榫確實卡住彈匣
Make sure to set the magazine upwards and connect it firmly until a click sound is heard.

警告 · 注意

- 請使用VFC製BB彈。
若因使用其他品質粗劣之BB彈所造成的故障，本公司一概不負責任。

WARNING · CAUTION

- Always use the VFC BB bullet for this air gun.
We will not be held responsible for any damage and accidents arising from use of bad quality bullets supplied by other manufacturers.

6-1 準星的調整 *Setting the Front Sight*

■ 折疊準星 *Use the Front Sight*

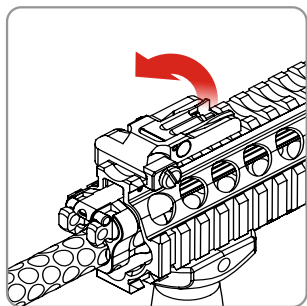

使用時向前折起
Turn the front sight to front when using.

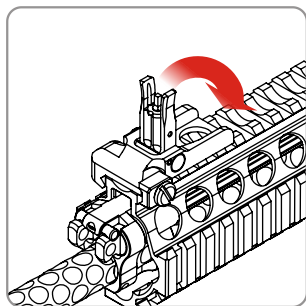

■ 準星調整 *Adjustment the Front Sight*

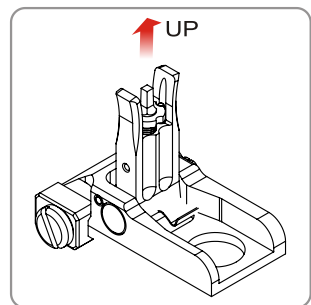
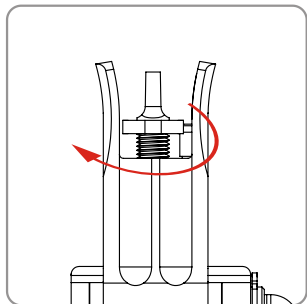

順時鐘旋轉上升
Turn it Clockwise will to raise up.

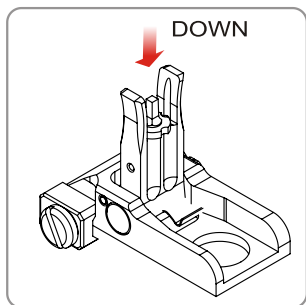
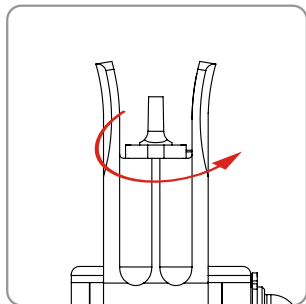

逆時鐘旋轉下降
Turn it to lower down.

6-2 照門的調整 *Setting the Rear Sight*

■ 折疊照門 *Use the Rear Sight*

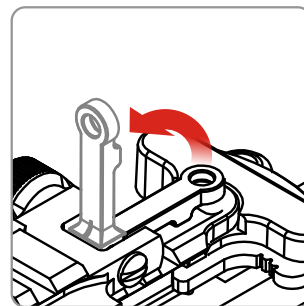

使用時向前折起
Turn the rear sight to front when using.

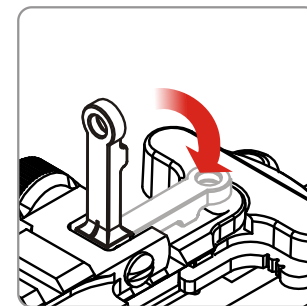

■ 風偏旋鈕調整 *Adjustment the Windage Knob*

照門左右風偏的調整：
轉動照門右側的風偏旋鈕，就可以調整照門的左右位置。
300M rear sight windage adjustment:
Turn the windage knob for windage adjustment.

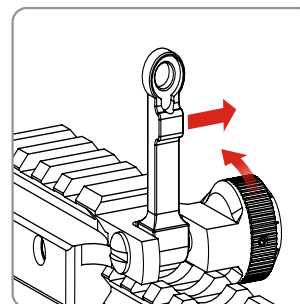

往前調整：照門將往右邊移動
Forward: Move the sight to right.

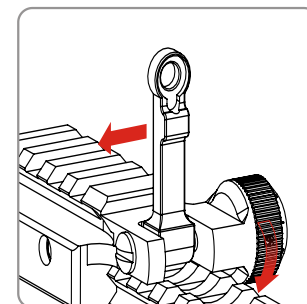

往後調整：照門將往左邊移動
Backward: Move the sight to left.

警告 · 注意

● 旋轉照門請小心勿被夾傷。

WARNING · CAUTION

● Be carefully and don't get hurt when turning the rear sight.

7 可 Moveable Parts and Accessories 動部與配件的說明

6.1 折疊槍托 Folding Stock

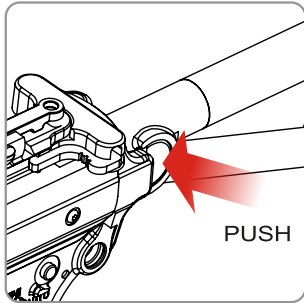

按下槍托釋放鈕

Push the stock release button

警告 · 注意

- 操作折疊槍托時，請小心勿被敲托夾傷。

WARNING · CAUTION

- Be carefully and don't get hurt when using the folding stock.

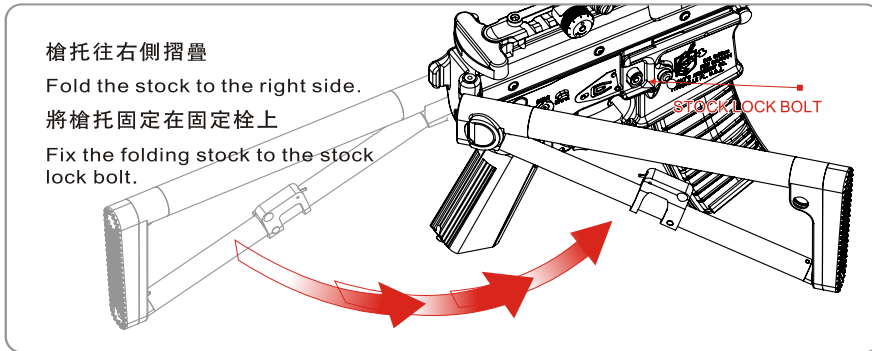

槍托往右側摺疊

Fold the stock to the right side.

將槍托固定在固定栓上

Fix the folding stock to the stock lock bolt.

6.2 滅音管 選配 / Optional parts

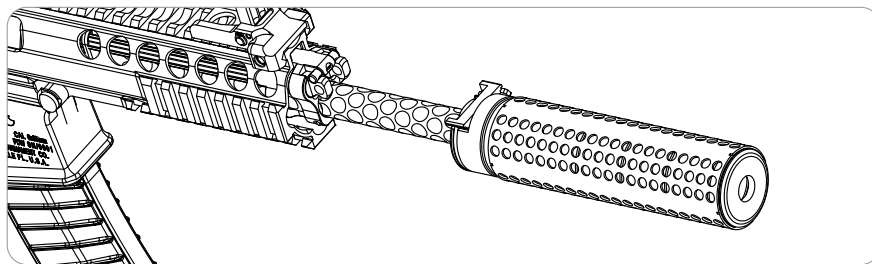

可安裝PDW專用NT3快拆滅音管於防火帽上

You can attach the NT3 Q.D. suppressor on the flash hider.

6.3 快拆式背帶環 Q.D. Sling Swivel

選配 / Optional parts

快拆背帶環有三個安裝處。

QD sling swivel has three position to install.

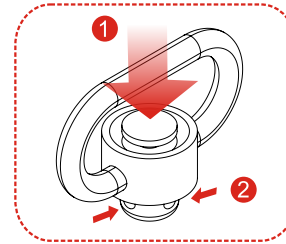

按壓扣環中間按鈕，可將快拆背帶環組裝或拆除。

Pressing the central button of the buckle to release or install the Q.D. sling swivel.

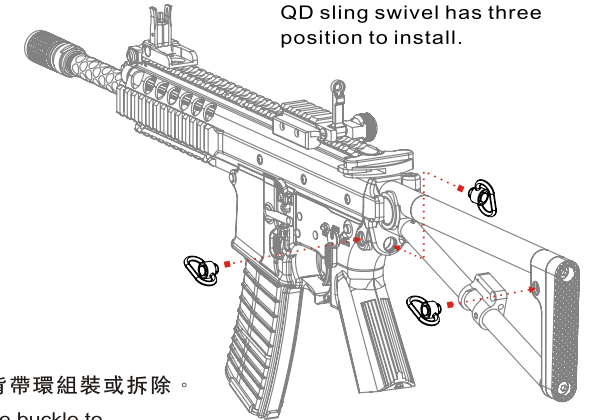

6.4 軌道護片 Rail Cover Panel 選配 / Optional parts

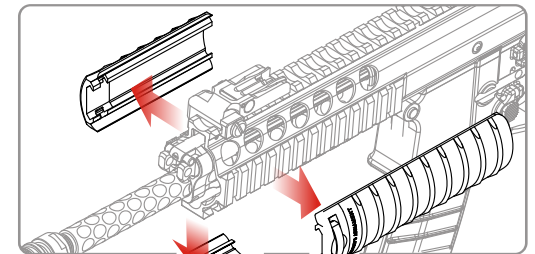
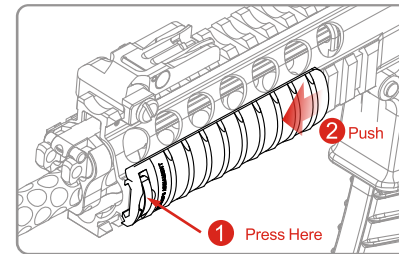

1. 將軌道護片前方的彈簧片向中間按壓。

Pressing the front clips of the rail cover panel toward the center.

2. 同時將軌道護木往前推，即可取出。

Simultaneously, push the rail cover panel forward and it can be taken out

6.5 戰術握把 Forward Pistol Grip

戰術握把下方旋鈕：

方向向下，順時針旋轉即可將握把取下。

The knob under the forward pistol grip face down the grip, twist clockwise and then the grip can be taken out.

選配 / Optional parts

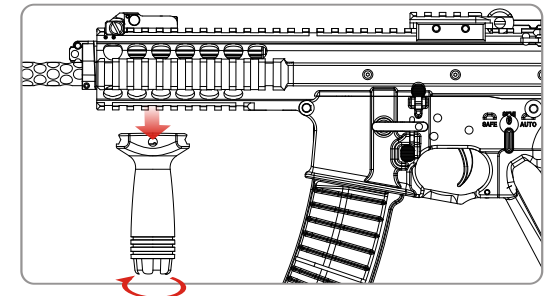

■ 6.6 槍機拉柄與槍機釋放 Charging and Bolt Catch

槍機拉柄可向後拉動，拉動槍機拉柄可使槍機固定在後，並露出HOP-UP調整鈕。
The Charging handle can be pulled and the dummy bolt will be fastened.

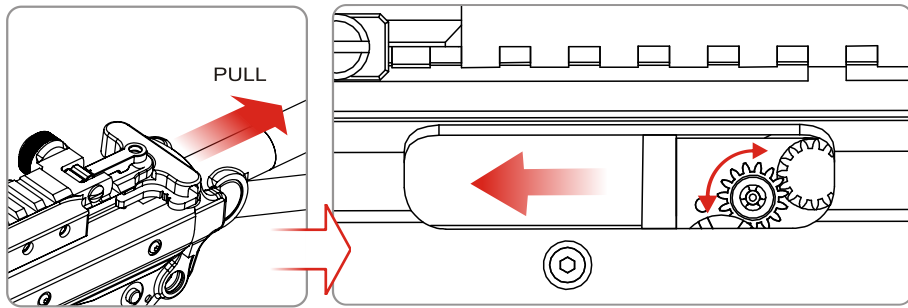

警告・注意

- 當槍機拉柄處於拉出狀態時，請勿將槍機拉柄推回，以免造成故障。

WARNING · CAUTION

- Don't push the charging handle forward while charging handle in the rear position.

當HOP-UP調整完畢要將槍機歸位時只需押下槍身左側的槍機釋放桿即可。
To Release bolt, just press the bolt catch.

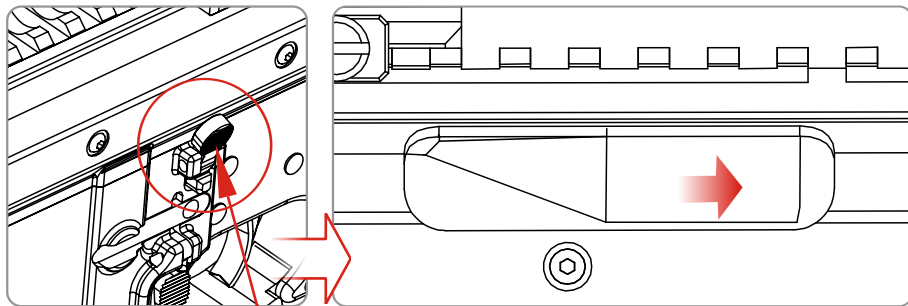

PRESS HERE

警告・注意

- 釋放槍機時，請小心勿被夾傷。

WARNING · CAUTION

- Be carefully and don't get hurt when press the bolt catch.

8 射擊 Firing

- ※確認完全安全的情況下，方可進行射擊。
- ※Confirm safety sufficiently before beginning firing.

Left Side
左側

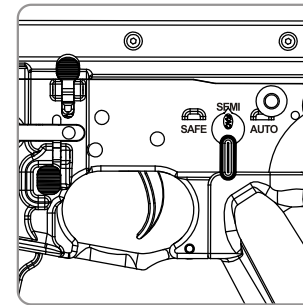

半自動位置
SEMI-AUTO

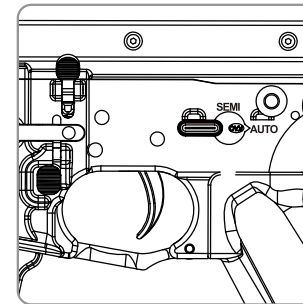

全自動位置
FULL-AUTO

Right Side
右側

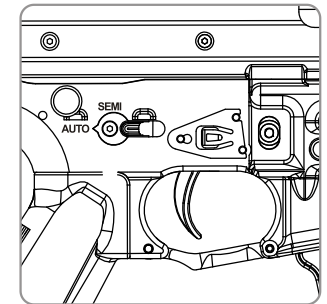
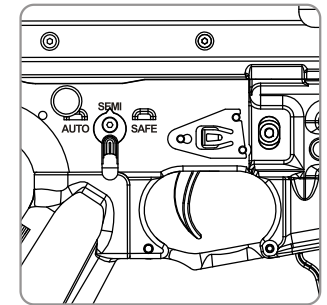

警告・注意

- 在半自動射擊時，有時會發生扣扳機卻沒有反應的情形。此時切換到全自動模式，射擊 5 ~ 6 發後，再切回半自動模式，將會恢復正常運作。

WARNING · CAUTION

- There are possible cases that no firing occurs after pulling the trigger in the semi auto mode. In this case, do not pull the trigger furiously. Fire 5 to 6 shots in the full auto mode and then return th the semi auto operation.

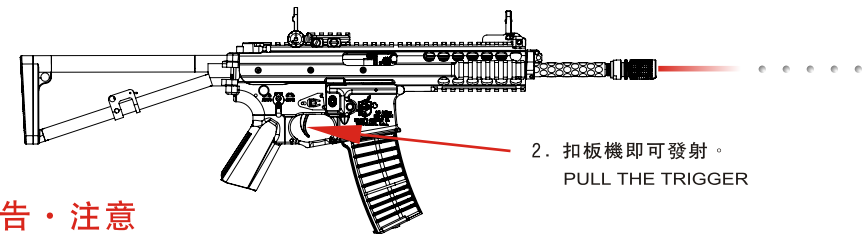

2. 扣扳機即可發射。
PULL THE TRIGGER

警告・注意

- 隨意扣動扳機非常危險，在確認射擊之前，請勿將手指放在扳機上。
- 裝上彈匣後，扣扳機第一發有可能是單發，此並非故障。

WARNING · CAUTION

- Activating the trigger carelessly is extremely dangerous. Never put your finger onto the trigger unless you are ready to shoot a target.
- A blank firing may occur at triggering after setting the magazine, this is the normal operation of the gun.

8 射擊 *Firing*

● 射擊終了時

- 拔下彈匣，往安全的方向全自動涉及2~3發，再切到半自動射擊1發以釋放彈簧，最後切回保險的位置。
- 彈匣雖未裝彈，但須注意槍膛內可能還會有殘彈。

● 馬達與電池的注意事項

- 射速減緩時，請將電池取下並予已充電。
- 馬達與電池在連續射擊500發之後，為避免過熱，請休息5~10分鐘。

● 卡彈時的處理

- 當卡彈發生時，將BB彈清理掉，並從彈匣進彈口噴入些許矽油，以保持含彈橡皮的潤滑度。

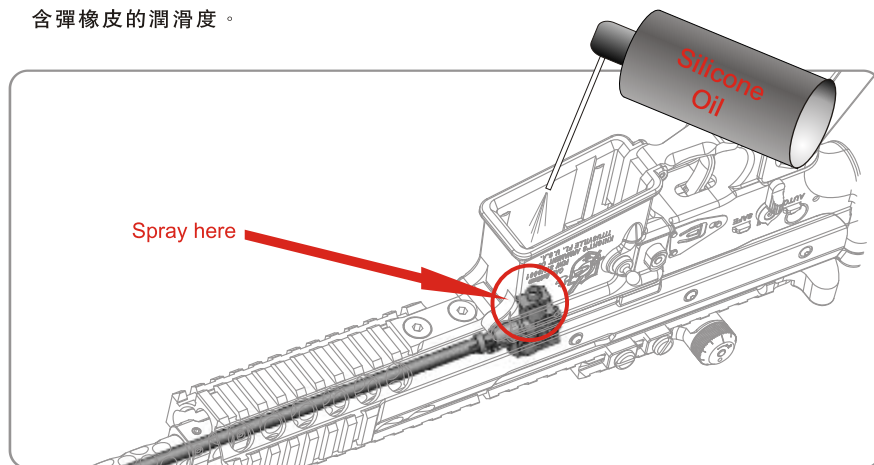

● After Operation

- Remove the magazine and dry fire the gun in the semi auto mode directing the muzzle to a safe direction. (Otherwise, the spring may be weakened.) Set the selector to the safe position.
- Bullets may remain in the chamber even if the magazine contains no bullets (or if the magazine is not connected).

● Cautions on Motor and Battery

- Charge the battery if the firing cycle becomes slow.
- give the air gun a rest for 5 to 10 minutes after firing about 500 rounds, in order to ensure long service lives of the motor and battery.

● When Bullets are Clogged

- If bullets are clogged, remove them and apply a few drops of silicone oil into the chamber from the magazine entrances or spray silicone oil for 0.5 to 1 sec to obtain smooth continuous firing.

警告・注意

- 請勿使用WD40、CRC556或其他礦物油。
- 射擊前請注意第二頁的警告事項。

WARNING・CAUTION

- Never use WD40, CRC556 or other mineral oil.
- Please read the warning on page 2 before shooting.

9 可變HOP-UP系統說明 *Variable HOP-UP System*

※在拉開槍機座調整Hop-Up時，慎防夾手。

※Be careful not to catch your fingers in the dummy bolt. By giving rotation of the fixed direction to BB bullet, a lift is

所謂的HOP-UP是藉由橡皮給BB彈特定的方向迴轉，使之保持上揚的力道而能增加飛行距離。而可變HOP-UP系統則是可微調讓彈道平整的系統。

By giving rotation of the fixed direction to BB bullet, a lift is given and it flies horizontally toward a long distance target. Variable Hop-Up system can tune finely that a spin starts.

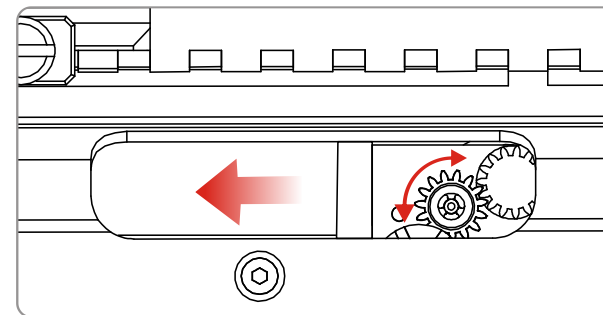
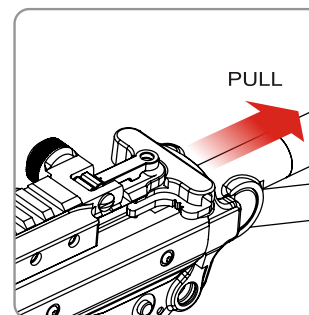

警告・注意

- Hop-Up調整過頭會造成卡彈。
卡彈時持續擊發則會造成齒輪箱內部零件損毀。所以調整過頭時而造成卡彈時，請停止射擊，並將Hop-Up釋放，重新調整。

WARNING・CAUTION

- Moving the dial too much towards Hop causes bullets to clog. Adjust again after stopping shooting immediately, returning the dial to the Normal side and canceling hop, since a piston and gears will be damaged, if it continues shooting then.

- 拉開槍機時，可以調整HOP-UP。
- 調整鈕往HOP的方向旋轉，則可以讓彈道上揚。
- 調整過頭或不足會影響彈道的表現。

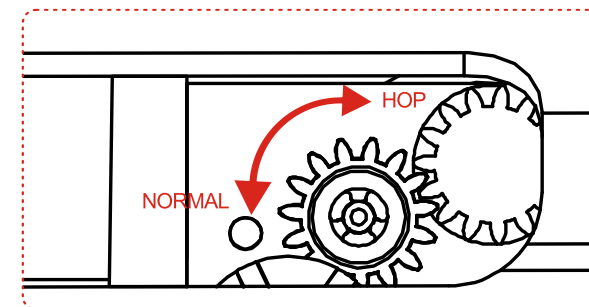

- Open bolt to adjust the Hop-Up system.
- Gradually turn the adjustment dial towards Hop to give hop up to bullets. (The best setting is where bullets fly horizontally.)
- Turning excessively adversely affects the trajectory. So, stop turning the dial when bullets fly horizontally.

9 可變HOP-UP系統說明

- 如下圖所示，BB彈保持水平彈道為最佳位置，而飛行距離也會增加。

The best position is where the bullets fly horizontally and the longest flying distance is obtained.

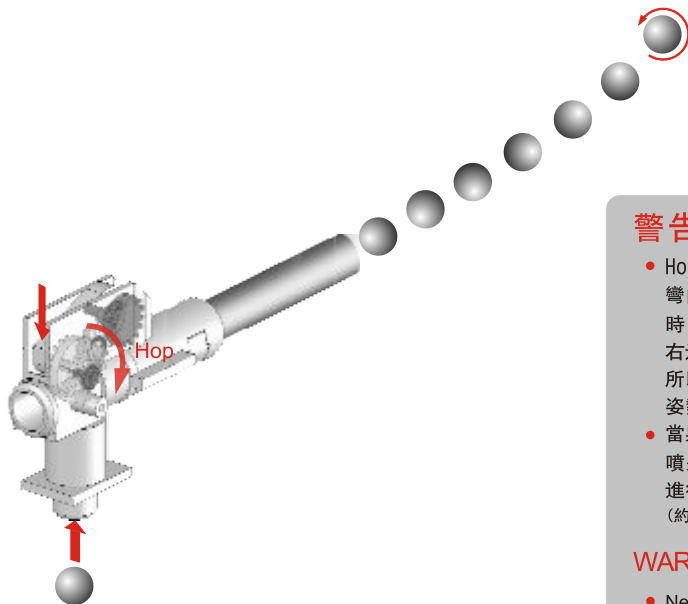
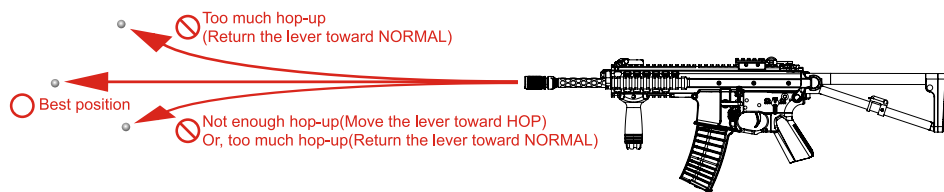

- 將HOP-UP往前調整會使彈道往上漂。
Forward Hop-Up, pellet will float up.
- 將HOP-UP往後調整可使彈道往下墜。
Backward Hop-Up, pellet will fall down.

警告・注意

- Hop-Up系統會造成彈道彎曲。若槍倒下來射擊時，BB彈會大幅度往左右邊飛行而造成危險。所以請保持正常的射擊姿勢。
- 當射擊10000發以上，可噴少許矽油在Hop橡皮以進行保養。(約0.5到1秒即可)

WARNING · CAUTION

- Never hold the gun sideways as the BB bullets will curve right or left. This is due to the Hop-Up system.
- When about 10,000 rounds are fired, spray silicone oil to the chamber for 0.5 to 1 sec.

9 可變HOP-UP系統說明 - 故障排除

狀態	原因	處理方法
彈著上飄	Hop-Up調整過頭	調整桿往前調整
BB彈飄不起來 (Hop-Up無作用)	Hop-Up調整過頭	調整桿往前調整
	Hop橡皮有油污附著	清除油污
	Hop橡皮破損	向經銷商或VFC購買零件來維修
無法調整	調整桿或其他零件損壞	向經銷商或VFC購買零件來維修
卡彈	Hop-Up調整過頭	調整桿向前調整，解除後再度調整
	BB彈不良	請使用VFC優質BB彈
	Hop橡皮髒污	清除髒污

Symptom	Cause	Action
Bullets flying upwards	Too much hop setting.	Gradually return adjustment lever towards Normal.
Short flying distance of bullets (less hop-up effect)	Too much hop setting.	Gradually return adjustment lever towards Normal.
	Hop packing contaminated by oil or dirt.	Clean using the cleaning rod or consult your dealer or VFC for repair
	Worn or damaged hop packing.	Purchase the replacement part at your dealer or from VFC and replace it.
Can not adjust	Damaged adjustment lever or other parts	Purchase the replacement part at your dealer or from VFC and replace it.
Frequent bullet clogging	Too much hop setting.	After the adjustment lever is returned to anormal side, and the hop is released, it adjusts again.
	Improper or too large sized BB bullets.	Use the BB bullet supplied by VFC.
	Dirty hop packing	Clean using the cleaning rod or consult your dealer or VFC for repair

狀態	原因	處理方法
無法動作	選擇鈕位於關保險位置	開保險。
	電池未充電	電池充電。
	電池接頭未連接	電池接頭確實連接。
	電池接頭正負極接反	正確連接電極。
	馬達老化(約5~6萬發)或接點不良	更換馬達或修理接點。
馬達有轉動但BB彈無法擊發	彈匣內BB彈卡彈	清除彈匣內的卡彈
	槍膛內BB彈卡彈	清除槍膛內的卡彈
	齒輪損壞	向經銷商或VFC購買零件來維修
無法全自動射擊	電池電力不足	電池充電。
	彈匣給彈不良	清除彈匣內的卡彈。
無法半自動射擊	齒輪未正確歸位	切到全自動射擊5~6發後，再切成半自動射擊。

狀態	原因	處理方法
無法半自動射擊	電池電力不足	電池充電。
	接點不良	向經銷商或VFC購買零件來維修。
連射速度低落	電池電力不足	電池充電
BB彈射程變短	槍膛橡皮磨損	向經銷商或VFC購買零件來維修
	氣筒O環磨損	
	氣筒彈簧彈性疲乏	
動作聲音異常	BB彈不良，太小或太重	請使用VFC優質BB彈
	矽油耗盡	在槍膛添加數滴矽油
	空擊太過造成齒輪異常	向經銷商或VFC購買零件來維修。
齒輪損壞		
BB彈從槍口掉落	空擊太過造成齒輪異常	請使用VFC優質BB彈
	槍膛橡皮磨損	
	BB彈太小	

Symptom	Cause	Action
No operation at all	Selector lever is set to safety .	Set the selector lever to fire.
	Battery is no charged.	Charge the battery .
	Battery connector is disconnected.	Connect the connector .
	The + and - of battery connector is reversed.	Connect the connector correctly .
	Fuse is blown out.	Replace the fuse.
Although motor is revolving gun doesn't fire	Bullets are clogged inside the magazine	Insert the charging rod into the magazine and move it up and down a few times to remove clogged bullets.
	Bullets are clogged in the chamber .	Remove clogged bullets using the cleaning rod.
	Faulty gear	Purchase the replacement gear from your dealer or VFC and repair .
Malfunction of full auto operation (automatic firing)	Insufficient battery power	Charge the battery .
	Faulty bullet feed of magazine	Repair clogging of the magazine.
Malfunction of semi-auto operation	Poor electrical connection	Consult your dealer or VFC for overhaul maintenance or repair .

Symptom	Cause	Action
Malfunction of semi-auto operation (single shot)	Insufficient battery power	Charge the battery .
	Poor electrical connection	Consult your dealer or VFC for overhaul maintenance or repair
Automatic firing cycles become slow	Insufficient battery power	Charge the battery .
Shooting distance becomes shorter	Worn or damaged chamber packing	consult your dealer or VFC for overhaul maintenance or repair . Replace the chamber packing., piston packing(O-ring) and piston assembly .
	Worn or damaged piston packing(O-ring)	
	Deteriorated piston spring	
	Faulty BB bullets (too small or heavy)	Use the genuine VFC BB bullets.
	Shortage of Silicone oil	Drop a few drops of silicone oil from under the chamber
Overly loud operating noise	Gear problems caused by excessive blank firing	consult your dealer or VFC for overhaul maintenance or repair . Replace the chamber packing., piston packing(O-ring) and piston assembly .
	Worn of damaged gear	
	Gear problem caused by excessive blank firing	
Bullets falling out from barrel end	Worn or damaged chamber packing	Use the genuine VFC BB bullets.

11 分解圖、零件表

- PDW 01 -Flash Hider
- PDW 02 -8"Front Barrel Set
- PDW 03 -10"Front Barrel Set
- PDW 04 -229mm Inner Barrel
- PDW 05 -285mm Inner Barrel
- PDW 06 -Dummy Bolt Plate
- PDW 07 -Piston
- PDW 08 -Rear Barrel Set
- PDW 09 -PDW Front Sight Set
- PDW 10 -Barrel Screw M6X20
- PDW 11 -Chamber Screw M6X16
- PDW 12 -PDW Upper Receiver Set
- PDW 13 -OPTIMA 300m Rear Sight
- PDW 14 -PDW Gas Block Set
- PDW 15 -Charging Handle
- PDW 16 -Hop-Up Chamber
- PDW 17 -Hop-Up Set
- PDW 18 -Selector Lever Gear Set
- PDW 19 -Gear Box Set
- PDW 20 -Motor Set
- PDW 21 -PDW Lower Receiver Set
- PDW 22 -Front Frame Lock Pin
- PDW 23 -Folding Stock Fixing Bolt
- PDW 24 -Clip

- PDW 25 -Right Selector Lever
- PDW 26 -Right Magazine Catch Set
- PDW 27 -Trigger Guard
- PDW 28 -Lock Pin
- PDW 29 -Left Selector Lever
- PDW 30 -Selector Lever Flap
- PDW 31 -Left Bolt Catch Set
- PDW 32 -Left Magazine Catch Set
- PDW 33 -PDW Magazine
- PDW 34 -Pistol Grip
- PDW 35 -Push-Button Swivel
- PDW 36 -Folding Stock Axle
- PDW 37 -Folding Stock
- PDW 38 -Forward Pistol Grip
- PDW 39 -2 Rib Rail Cover Panel
- PDW 40 -5 Rib Rail Cover Panel
- PDW 41 -9 Rib Rail Cover Panel
- PDW 42 -Battery Box

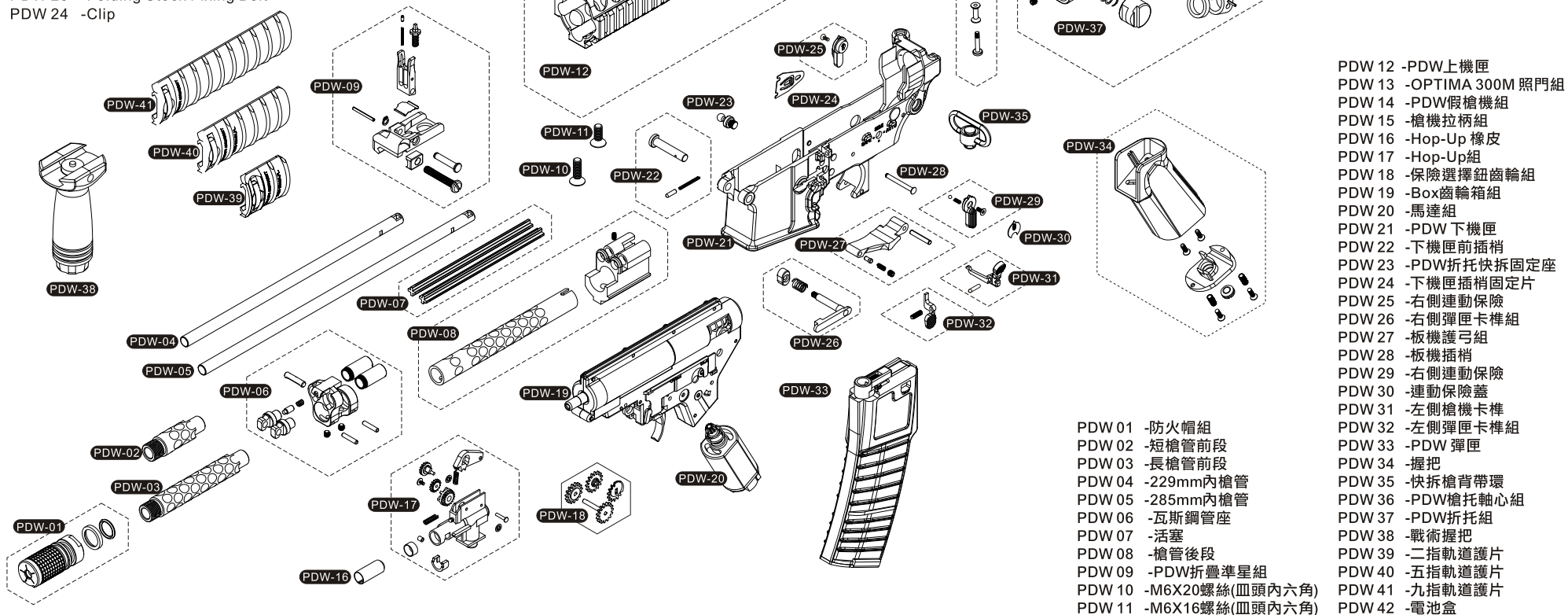

- PDW 12 -PDW上機匣
- PDW 13 -OPTIMA 300M 照門組
- PDW 14 -PDW假槍機組
- PDW 15 -槍機拉柄組
- PDW 16 -Hop-Up 橡皮
- PDW 17 -Hop-Up組
- PDW 18 -保險選擇鈕齒輪組
- PDW 19 -Box齒輪箱組
- PDW 20 -馬達組
- PDW 21 -PDW 下機匣
- PDW 22 -下機匣前插梢
- PDW 23 -PDW折托快拆固定座
- PDW 24 -下機匣插梢固定片
- PDW 25 -右側連動保險
- PDW 26 -右側彈匣卡榫組
- PDW 27 -板機護弓組
- PDW 28 -板機插梢
- PDW 29 -右側連動保險
- PDW 30 -連動保險蓋
- PDW 31 -左側槍機卡榫
- PDW 32 -左側彈匣卡榫組
- PDW 33 -PDW 彈匣
- PDW 34 -握把
- PDW 35 -快拆槍背帶環
- PDW 36 -PDW槍托軸心組
- PDW 37 -PDW折托組
- PDW 38 -戰術握把
- PDW 39 -二指軌道護片
- PDW 40 -五指軌道護片
- PDW 41 -九指軌道護片
- PDW 42 -電池盒

【有限保固】

- 本產品自購買日起，本公司提供一個月或30,000發的有限保固(以先達到條件者為準)。
- 保固範圍：齒輪箱內部零件。(不包含馬達)
- 本產品經過嚴密之檢查與試驗，在保證期間內產品因正常使用而發生故障，經本公司認證之技術人員確認為製造或材料上之瑕疵時，本公司將負責免費維修。
- 以下情形，本公司將不負責保證責任：
 - 未登錄槍之序列號碼者。
 - 非本公司認證之技術人員修裝而導致之故障。
 - 經查驗非本公司經銷商所銷售之槍型，無法提供註冊卡及經銷商蓋印章者。
 - 因火災或其他天災、地變等因素所導致之故障。

【零件維修】

- 本產品在正確及適當的使用方法下操作，約30000發以後，Hop-Up橡皮等消耗性零件仍有交換的必要。像是超過保固期限的耗材，或因操作疏失所發生的故障以及保養的場合，可透過經銷商或直接向本公司訂購備用零件。
- 有序列號碼的零件本公司無法提供相同序列號碼的零件。
- 訂購的方法請參考VFC網站<http://www.gb-tech.com.tw>
- 下列行為本公司將不提供保固，亦不提供零件服務：
 - 任何外觀上的改造或變更原來內部構造所發生之故障。
 - 未依說明書所示之正確使用方法，不論是故意或過失因素所發生之故障。

Limited Warranty

- Vega Force Company (VFC) warrants the AK-74 AEG against defects in materials and workmanship for a period of one month or 30,000 rounds BB bullets shoot from the date of original purchase ("Warranty Period").
- Warranty coverage: Internal parts of gearbox. The cosmetic parts and electric motor are not cover by warranty.
- We inspect and test each product before delivery to customer. In warranty period, the repair service will be provide by ours certify technician after determine the problem or damage defects in materials and workmanship.
- This warranty does not apply: (a) to damage caused by accident, abuse, misuse, misapplication, or non-VFC products; (b) to a product or a part that has been modified without the written permission of VFC or his agent; or (c) to no register your series number with VFC with in 7 days of purchase date; (d) to if any VFC serial number has been removed or defaced; or (e) to disassembly or modify by unauthorized person; (f) to the products not purchase from VFC authorize dealer with valid warranty card.

Maintenance & Replacement Parts

- The Hop-Up bucking and few parts will be recommended to change each 30,000 rounds BB bullets shoot.
- We may unable to provide match series number on replacement parts.
- If you unable to obtain locally, Please check <http://www.gb-tech.com.tw> for more information.



■ PDW專用NT3快拆減音
NT3 Q.D. suppressor for PDW used.



■ 8 英寸轉接外管
8 inch outer barrel



■ 快拆背帶環
Knight Type Q. D. Sling Swivel



■ PDW專用彈匣
Magazine for PDW use only.

14 Coming soon 近期發售



EGLM MK13 MOD 0